

AURORA COUNTY SOUTH DAKOTA

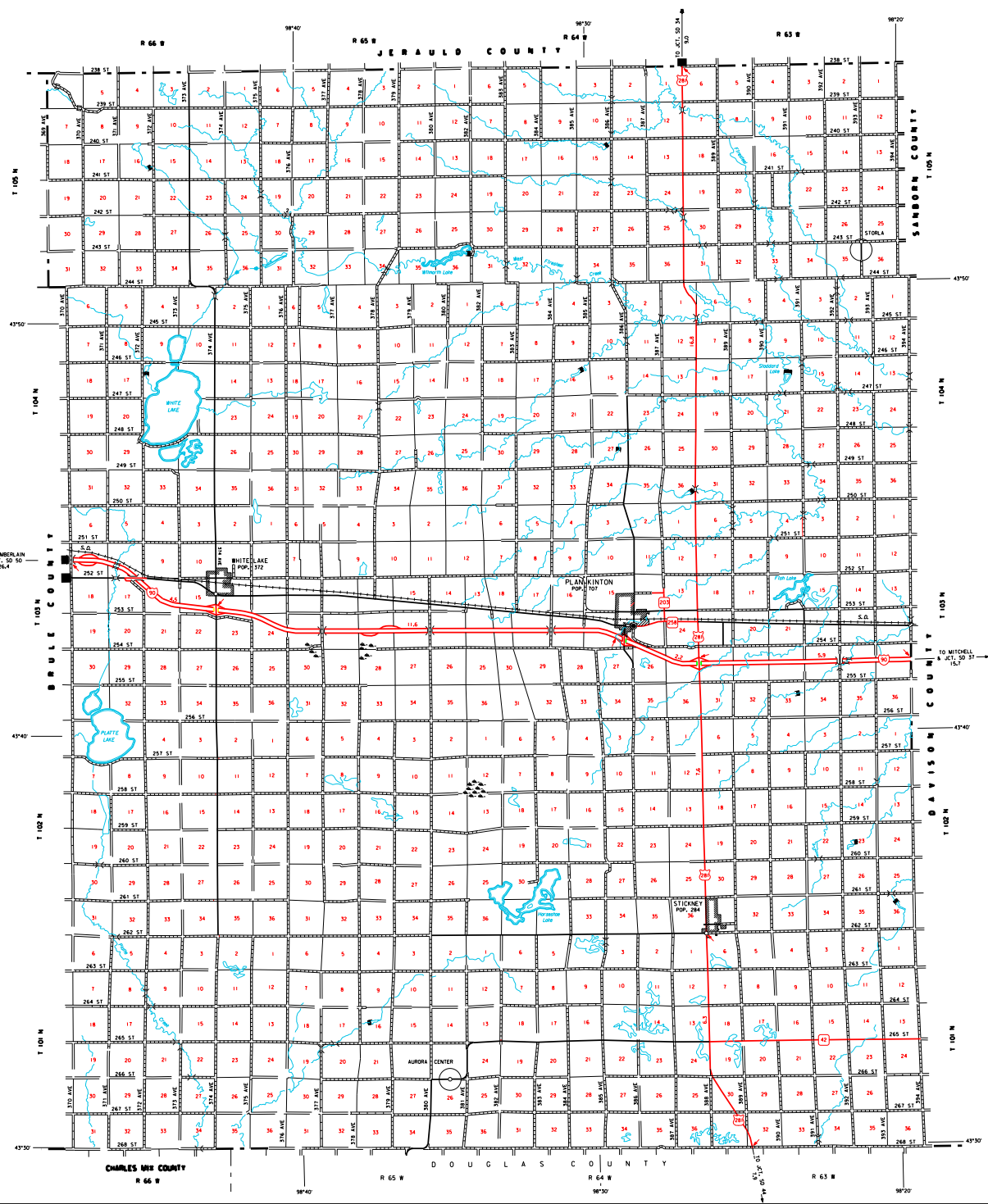

LEGEND

- INTERSTATE HIGHWAY (FULL CONTROL OF ACCESS)
- U.S. NUMBERED HIGHWAY
- STATE NUMBERED HIGHWAY
- FEDERAL AID HIGHWAY SYSTEM
- FEDERAL AID SECONDARY HIGHWAY SYSTEM
- END OF FEDERAL AID DESIGNATED ROUTE
- PRIVATE ROAD
- UNIMPROVED ROAD
- GRAVEL AND DRAINED ROAD
- GRAVEL OR STONE SURFACED ROAD
- PAVED SURFACED ROAD
- DIVIDED HIGHWAY (WITH FRONTAGE ROAD)
- INTERCHANGE
- HIGHWAY GRADE SEPARATION
- POINTS AT WHICH BRIDGE DISTANCES ARE MEASURED INDICATED THIS WAY
- RAILROAD
- RAILROADS IN ANTICIPATION
- TWO OR MORE TRACKS OF SEPARATELY OPERATED COMPANIES OR EQUIPMENT ROAD-OF-RAIL
- RAILROAD CROSSINGS
- GRADE CROSSINGS
- RAILROAD ABOVE
- RAILROAD BELOW
- AIRPORT WITH SURFACED RUNWAYS
- MILITARY FIELD
- AIRPORT, COMPLETE FACILITIES (COMMERCIAL OR MUNICIPAL)
- AIRFIELD, LIMITED FACILITIES
- LANDING AREA OR STRIP
- WELLING PRIVATE AIR FIELD
- ARMY LIGHT BEACON (GENERAL)
- NARROW STREAM
- WIDE STREAM, INTERMITTENT WINDGATE
- DRAINAGE DITCH (MAN)
- IRRIGATION DITCH
- RESERVOIR, FORD OR LAKE
- RESERVOIR, WITH DAM
- DAM
- MARSH OR SWAMP LAND
- DOCK, PIER, OR LANDING
- HIGHWAY BRIDGE OVER 20 FT. IN LENGTH
- HIGHWAY BRIDGES CLOSELY SPACED
- STEEL TRUSS BRIDGE, LARGE
- CANTILEVER BRIDGE
- FORD - ROAD ESTABLISHED
- CONCRETE FORD
- CAUSEWAY
- CATTLE GUARD
- PROMONT ELEVATION
- STATE LINE
- COUNTY LINE
- CONGRESSIONAL TOWNSHIP LINE
- SECTION LINE
- FEDERAL AND STATE RESERVATION BOUNDARY LINE
- MONUMENT (SMALL)
- COUNTY SEAT
- OTHER CITIES AND VILLAGES
- UNINCORPORATED VILLAGE OR AREA OF CONGESTED CULTURE
- INCORPORATED CITY OR VILLAGE (FIGURES INDICATED 1990 POPULATION)

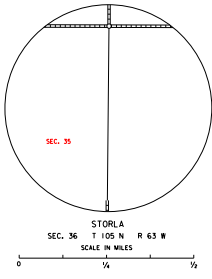
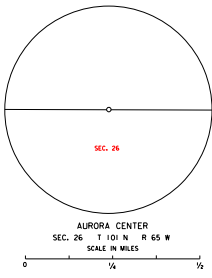

GENERAL HIGHWAY MAP
AURORA COUNTY
SOUTH DAKOTA

prepared by the
SOUTH DAKOTA DEPARTMENT OF TRANSPORTATION
in cooperation with the
U.S. DEPARTMENT OF TRANSPORTATION
FEDERAL HIGHWAY ADMINISTRATION

SCALE
0 2 4 5 MILES

2017



UNIVERSAL TRANSVERSE MERCATOR PROJECTION

RESTRICTION OF LIABILITY: The South Dakota Department of Transportation makes no special guarantee of completeness, accuracy, or timeliness of information provided on this map. It is the user's responsibility to verify the accuracy of any data, including, but not limited to, the representation of boundaries and features for a particular purpose to which it may be put.

COPIES OF THIS MAP ARE AVAILABLE FOR PUBLIC USE AT A NOMINAL COST
S.D. Department of Transportation
400 S.W. - P.O. BOX 2772 SIOUX FALLS, SD 57107

AURORA COUNTY SOUTH DAKOTA