

LEGEND

- INTERSTATE HIGHWAY (FULL CONTROL OF ACCESS)
- U.S. NUMBERED HIGHWAY
- STATE NUMBERED HIGHWAY
- PRIMITIVE ROAD
- UNIMPROVED ROAD
- GRAVEL AND DRAINED ROAD
- GRAVEL OR STONE SURFACED ROAD
- HARD SURFACED ROAD
- DIVIDED HIGHWAY (WITH FRONTAGE ROAD)
- INTERCHANGE
- HIGHWAY GRADE SEPARATION
- POINTS BETWEEN WHICH DISTANCES ARE MEASURED INDICATED THIS
- RAILROAD
- RAILROADS IN JUNCTION
- RAIL IN MAIN TRACKS OF SEPARATELY OPERATED COMPANIES OR ADJACENT RIGHT-OF-WAY
- RAILROAD CROSSINGS
- RAILROAD ABOVE
- RAILROAD BELOW
- AIRPORT WITH SURFACED RUNWAYS
- MILITARY FIELD
- AIRPORT, COMPLETE FACILITIES (COMMERCIAL OR MUNICIPAL)
- AIRFIELD, LIMITED FACILITIES
- LANDING AREA OR STRIP
- INCLUDING PRIVATE AIR FIELDS
- AIRWAY LIGHT BEACON (GENERAL)
- NARROW STREAM
- WIDE STREAM (INTERMITTENT NAVIGATION)
- DRAINAGE DITCH (MAIN)
- IRRIGATION DITCH
- RESERVOIR, POND OR LAKE
- RESERVOIR, WITH DAM
- DAM
- MARSH OR SWAMP LAND
- DOCK, PIER, OR LANDING
- HIGHWAY BRIDGE (OVER 20 FT. IN LENGTH)
- BRIDGE (OTHER THAN HIGHWAY)
- HIGHWAY BRIDGES CLOSELY SPACED
- STEEL TRUSS BRIDGE LARGE
- CANTILEVER BRIDGE
- FORD - ROAD ESTABLISHED
- CONCRETE FORD
- CAUSEWAY
- CATTLE GUARD
- PROMINENT ELEVATION
- STATE LINE
- COUNTY LINE
- CONGRESSIONAL TOWNSHIP LINE
- SECTION LINE
- FEDERAL AND STATE RESERVATION BOUNDARY LINE
- MONUMENT (SMALL)
- COUNTY SEAT
- OTHER CITIES AND VILLAGES
- UNINCORPORATED VILLAGE OR AREA OF CONGESTED CULTURE
- INCORPORATED CITY OR VILLAGE (FIGURES INDICATE 1990 POPULATION)
- FOREST RANGER STATION
- BATHING BEACH OR SWIMMING POOL
- PLAYGROUND, BALL FIELD, ETC.
- CAMP SITE, NO PERMANENCE
- PICNIC GROUND
- SCENE SITE
- TOURIST COURT OR MOTEL
- CAMP OR LODGE
- FISH HATCHERY
- REST AREA
- SOFT COURSE OR COUNTRY CLUB
- AMUSEMENT HALL OR PARK
- SMALL PARK (SP - STATE, WP - WAYSIDE PARK, MP - MUNICIPAL PARK)
- FARMHOUSE, RACE COURSE, SPEEDWAY
- DRIVE - IN THEATRE
- FARM UNIT
- DRINKING FOUNTAIN
- ROW OR GROUPS OF DWELLINGS CLOSELY SPACED
- COMBINED DWELLING AND STORE OR SMALL BUSINESS
- DWELLING, BUSINESS, AND FILLING STATION
- DWELLING, BUSINESS, FILLING STATION, AND POST OFFICE
- STATE POINT OF ENTRY OR BOUND STATION
- SEASONAL OR SUMMER COLONY DWELLING
- SEASONAL DWELLINGS CLOSELY SPACED
- CHURCH - OTHER RELIGIOUS INSTITUTION
- CENOTAPH
- CHURCH WITH CEMETARY ADJACENT
- STONE OR SMALL BUSINESS ESTABLISHMENT
- DWELLING, BUSINESS, AND FILLING STATION
- BUSINESS AND POST OFFICE
- FILLING STATION
- MINE
- BEAR TRAP
- Gauging or Pumping Station (General)
- STOCK YARD - LOADING PEN OR CORRAL
- GRAVEL PIT
- SHAW ELEVATION (OVER 20 FT. IN LENGTH)
- WAREHOUSE (GENERAL, LOUVEY, AND US OR STATE)
- NURSERY
- SCHOOLHOUSE
- CONGREGATIONAL CHURCH - LARGE SCHOOL
- OTHER EDUCATIONAL INSTITUTION
- TOWNHALL, GRANGE, OR COMMUNITY HALL
- ADMINISTRATION BUILDING
- POST OFFICE
- HIGHWAY GARAGE (COUNTY, STATE OR FEDERAL)
- WATER SUPPLY STAND PIPE OR TANK
- COMMUNICATION TOWER - TELEPHONE, NEA ETC.
- POWER SUBSTATION
- RADIO OR TV STATION (WITH CALL LETTERS)
- RADIO RANGE STATION
- GARAGE OR RUBBER DUMP
- SENSE DISPOSAL PLANT
- TRAMMILLION STATION
- LOCATION OF CULTURE WHERE MAP SCALE DOES NOT PERMIT PLACING OF SYMBOL

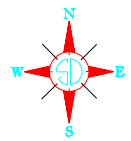
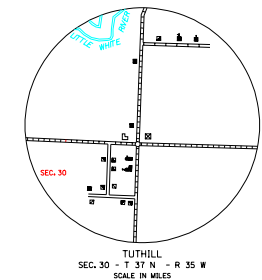
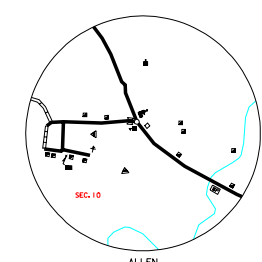

GENERAL HIGHWAY MAP
BENNETT COUNTY
 SOUTH DAKOTA

prepared by the
 SOUTH DAKOTA DEPARTMENT OF TRANSPORTATION
 in cooperation with the
 U.S. DEPARTMENT OF TRANSPORTATION
 FEDERAL HIGHWAY ADMINISTRATION

SCALE
 0 1 2 3 4 5 MILES

2006

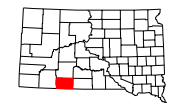

UNIVERSAL TRANSVERSE MERCATOR PROJECTION
 U.S. and State numbered Highways and
 the Federal-Aid Primary and Federal-Aid
 Secondary systems as of May 31, 1986

MAP PRODUCED
 BY
 CARTOGRAPHIC
 SECTION
 SOUTH DAKOTA
 DEPARTMENT OF TRANSPORTATION

COPIES OF THIS MAP ARE AVAILABLE
 FOR PUBLIC USE AT A NOMINAL COST
 S.D. Department of Transportation
 Map Scale - 1" = 1/4" 000773 2006
 Pierre, South Dakota 57501