

LEGEND

INTERSTATE HIGHWAY (FULL CONTROL OF ACCESS)	US NUMBERED HIGHWAY	STATE NUMBERED HIGHWAY	FEDERAL AID HIGHWAY SYSTEM	FEDERAL AID SECONDARY HIGHWAY SYSTEM	END OF FEDERAL AID DESIGNATED ROUTE	NARROW STREAM (INTERMITTENT NAVIGATION)	WIDE STREAM (INTERMITTENT NAVIGATION)	DRAINAGE DITCH (MAIN)	IRRIGATION DITCH	RESERVOIR, POND OR LAKE	RESERVOIR, WITH DAM	DAM	MARSH OR SWAMP LAND	DOCK, PIER, OR LANDING	HIGHWAY BRIDGE (OVER 20 FT. IN LENGTH)	HIGHWAY BRIDGES CLOSELY SPACED	STEEL TRUSS BRIDGE (LONG)	CANTILEVER BRIDGE	FORD - ROAD ESTABLISHED	CONCRETE FORD	CAUSEWAY	CATTLE GUARD	PROMINENT ELEVATION	STATE LINE	COUNTY LINE	CONGRESSIONAL TOWNSHIP LINE	SECTION LINE	FEDERAL AND STATE RESERVATION BOUNDARY LINE	HIGHWAY (SMALL)	COUNTY SEAT	OTHER CITIES AND VILLAGES	UNINCORPORATED VILLAGE OR AREA OF CONGESTED CULTURE	INCORPORATED CITY OR VILLAGE (FIGURES INDICATE 1990 POPULATION)
PRIMITIVE ROAD	UNIMPROVED ROAD	GRADED AND DRAINED ROAD	GRAVEL OR STONE SURFACED ROAD	PAV SURFACED ROAD	DIVIDED HIGHWAY (WITH FRONTAGE ROAD)	INTERCHANGE	HIGHWAY GRADE SEPARATION	POINTS BETWEEN WHICH DISTANCES ARE MEASURED INDICATED THUS	RAILROAD IN Juxtaposition	TWO OR MORE TRACKS OF SEPARATELY OPERATED COMPANIES ON ADJACENT RIGHT-OF-WAY	RAILROAD CROSSINGS	RAILROAD ABOVE	RAILROAD BELOW	RAILROAD WITH SURFACED RUNWAYS	MILITARY FIELD	ARRIPOY, COMPLETE FACILITIES (COMMERCIAL OR MUNICIPAL)	ARRIPOY, LIMITED FACILITIES	LANDING AREA OR STRIP (INCLUDING PRIVATE AIR FIELDS)	ARMY LIGHT BEACON (GENERAL)														

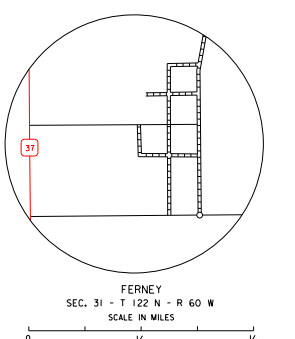
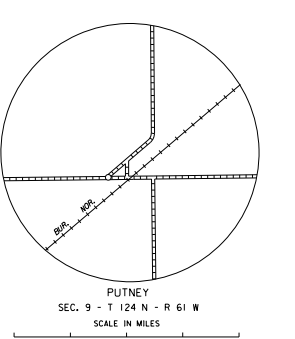
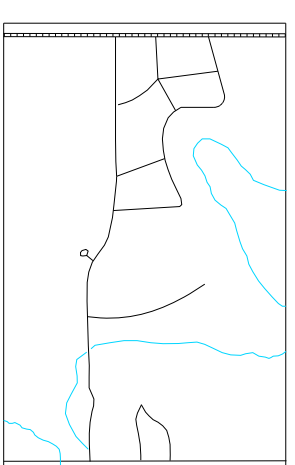

GENERAL HIGHWAY MAP
SOUTH HALF
BROWN COUNTY
SOUTH DAKOTA

prepared by the
SOUTH DAKOTA DEPARTMENT OF TRANSPORTATION
in cooperation with the
U.S. DEPARTMENT OF TRANSPORTATION
FEDERAL HIGHWAY ADMINISTRATION

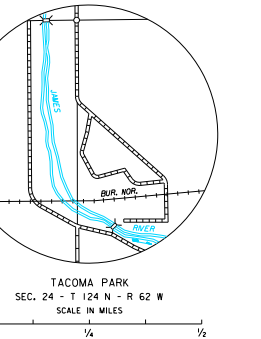
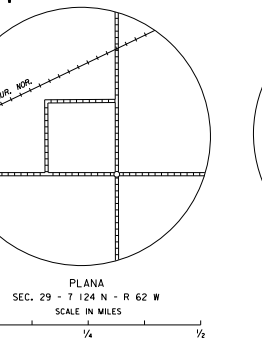
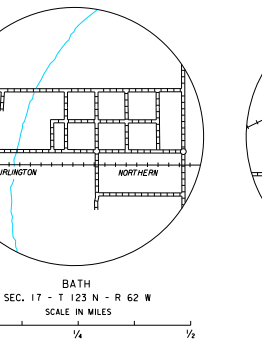
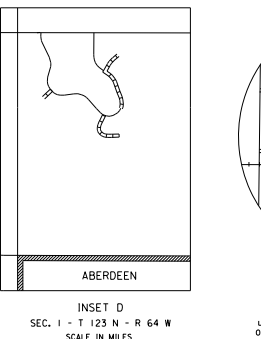
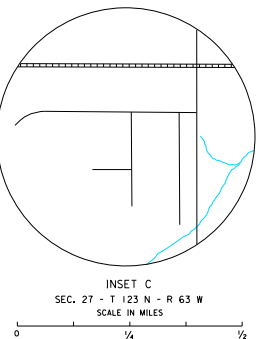
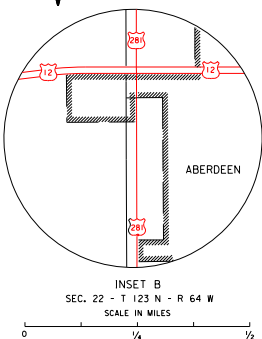
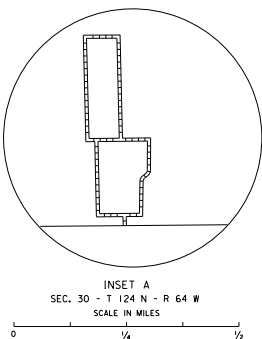
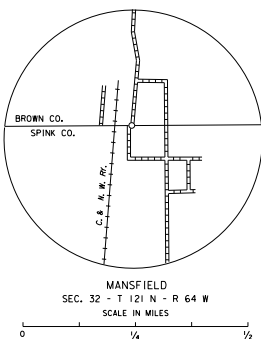
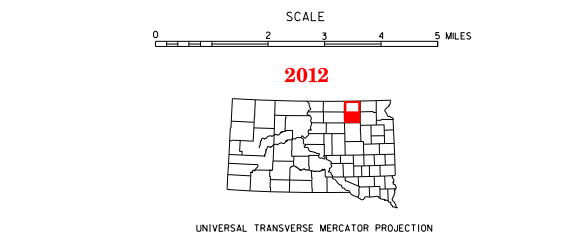

RESTRICTION OF LIABILITY: The South Dakota Department of Transportation makes no claims, promises or guarantees about the accuracy, completeness or adequacy of the data and expressly disclaims liability for errors and omissions of the data contents, including but not limited to the warranties of non-infringement of third party rights, title, merchantability and fitness for a particular purpose is given with respect to this data.