

SECTION 28 - T8N - R6E BUTTE COUNTY SOUTH DAKOTA

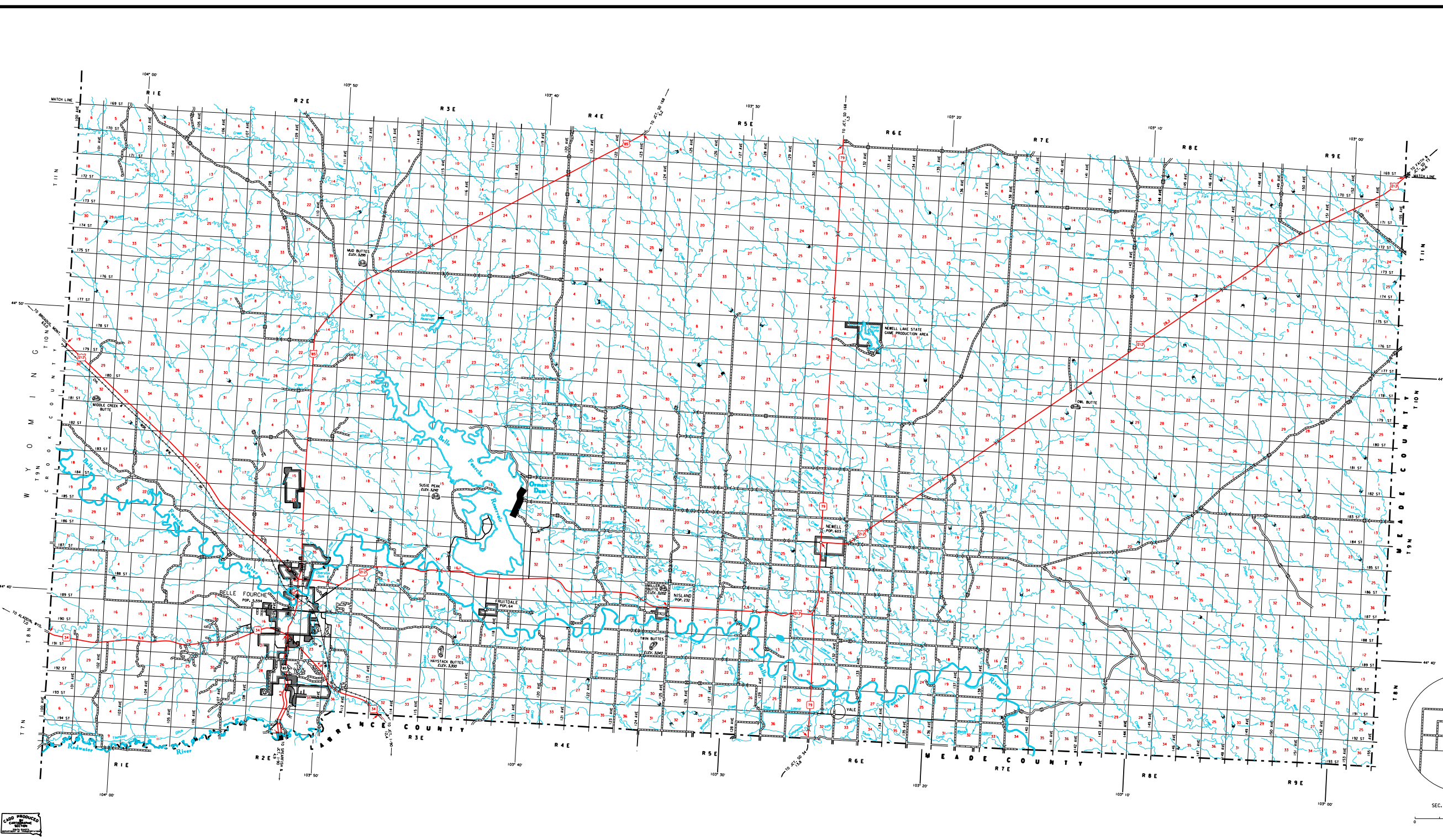

LEGEND

INTERSTATE HIGHWAY (FULL CONTROL OF ACCESS)	ROAD WITH INTERSECTION NAVIGATION
U.S. NUMBERED HIGHWAY	ORANGE DITCH (MAIN)
STATE NUMBERED HIGHWAY	IRRIGATION DITCH
FEDERAL AID HIGHWAY SYSTEM	RESERVOIR, POND OR LAKE
FEDERAL AID SECONDARY HIGHWAY SYSTEM	RESERVOIR, WITH DAM
END OF FEDERAL AID DESIGNATED ROUTE	WADY OF STREAM LAKE
PRIVATE ROAD	ROCK, PEAK, OR LAKE
UNIMPROVED ROAD	HIGHWAY BRIDGE (OVER 30 FT. IN LENGTH)
GRAVEL AND SHIMMER ROAD	HIGHWAY BRIDGE (CLOSELY SPACED)
GRAVEL OR STONE SURFACED ROAD	STEEL TRUSS BRIDGE LARGE
HARD SURFACED ROAD	CONCRETE BRIDGE
DIVIDED HIGHWAY (20' SIDE SLOPE ROAD)	FORD - ROAD ESTABLISHED
INTERCHANGE	CONCRETE FORD
HIGHWAY GRADE SEPARATION	CADENET
POINTS BETWEEN WHO DISTANCES	CATTLE GUARD
RAILROADS IN RESTRICTION	PROMINENT ELEVATION
TWO OR MORE TRACKS OF SEPARATELY OPERATED COMPANIES OR ADJACENT RIGHT-OF-WAY	STATE LINE
RAILROAD CROSSING	COUNTY LINE
RAILROAD CROSSING	SECTION LINE
RAILROAD ABOVE	FEDERAL AND STATE RESERVATION BOUNDARY LINE
RAILROAD BELOW	CONGRESSIONAL TOWNSHIP LINE
RAILROAD WITH SURFACE	COUNTY SEAT
RAILROAD WITH SURFACE	OTHER CITIES AND VILLAGES
RAILROAD WITH SURFACE	INCORPORATED VILLAGE OR AREA OF CONCRETE OR LAKE
RAILROAD WITH SURFACE	POP. 250
RAILROAD WITH SURFACE	POP. 100
RAILROAD WITH SURFACE	POP. 50
RAILROAD WITH SURFACE	POP. 25
RAILROAD WITH SURFACE	POP. 10
RAILROAD WITH SURFACE	POP. 5
RAILROAD WITH SURFACE	POP. 2
RAILROAD WITH SURFACE	POP. 1
RAILROAD WITH SURFACE	POP. 0

GENERAL HIGHWAY MAP
SOUTH HALF
BUTTE COUNTY
SOUTH DAKOTA

prepared by the
SOUTH DAKOTA DEPARTMENT OF TRANSPORTATION
in cooperation with the
U.S. DEPARTMENT OF TRANSPORTATION
FEDERAL HIGHWAY ADMINISTRATION

SCALE
0 1 2 3 4 5 MILES

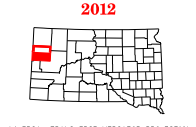

UNIVERSAL TRANSVERSE MERCATOR PROJECTION

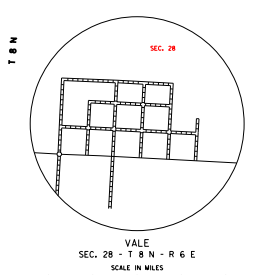

VALE
SCALE IN MILES
0 1/4 1/2 3/4 1

RESTRICTION OF LIABILITY: The South Dakota Department of Transportation makes no warranty, express or implied, about the accuracy, completeness or timeliness of the information contained herein. The user of this information assumes all liability for any and all losses, damages or expenses, including reasonable attorneys' fees, that may be incurred by the user as a result of the use of this information. The user agrees to hold the South Dakota Department of Transportation harmless for any and all such losses, damages or expenses.

COPIES OF THIS MAP ARE AVAILABLE FOR PUBLIC USE AT A NOMINAL COST
S.D. Department of Transportation
Map Sales - P.O. Box 773, 2049
Pierre, South Dakota 57508