

GENERAL HIGHWAY MAP DEWEY COUNTY SOUTH DAKOTA SOUTH HALF

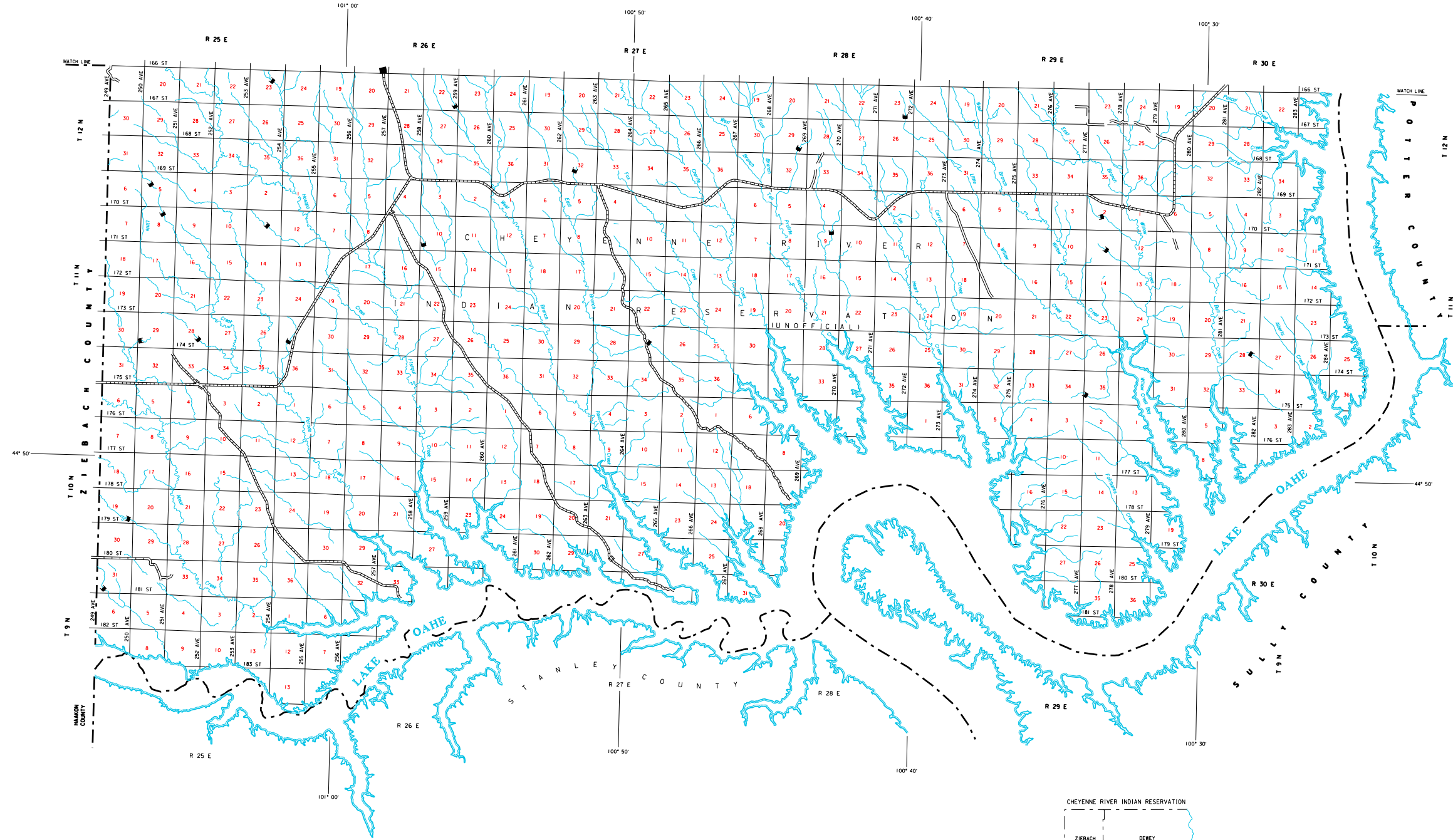

**LEGEND**

|  |  |   |  |
|--|--|---|--|
| INTERSTATE HIGHWAY (FULL CONTROL OF ACCESS)                                  |  | NARROW STREAM                                       |  |
| U.S. NUMBERED HIGHWAY  |  | WIDE STREAM (INTERMITTENT NAVIGATION)               |  |
| STATE NUMBERED HIGHWAY   |  | DRAINAGE DITCH (MAN)                                |  |
| FEDERAL AID HIGHWAY SYSTEM   |  | IRRIGATION DITCH                                    |  |
| FEDERAL AID SECONDARY HIGHWAY SYSTEM   |  | RESERVOIR, POND OR LAKE                             |  |
| END OF FEDERAL AID DESIGNATED ROUTE  |  | RESERVOIR, WITH DAM                                 |  |
|  |  | DAM   |  |
|  |  | MARSH OR SWAMP LAND                                 |  |
| PRIMITIVE ROAD   |  | DOCK, PIER, OR LANDING                              |  |
| UNIMPROVED ROAD  |  | HIGHWAY BRIDGE (OVER 20 FT. IN LENGTH)              |  |
| GRAVEL AND DRAINED ROAD  |  | HIGHWAY BRIDGES CLOSELY SPACED                      |  |
| GRAVEL OR STONE SURFACED ROAD  |  | STEEL TRUSS BRIDGE LARGE                            |  |
| HARD SURFACED ROAD   |  | CANTILEVER BRIDGE                                   |  |
| DIVIDED HIGHWAY (WITH FRONTAGE ROAD)   |  | FORD - ROAD ESTABLISHED                             |  |
| INTERCHANGE  |  | CONCRETE FORD                                       |  |
| HIGHWAY GRADE SEPARATION   |  | CAUSEWAY  |  |
| POINTS BETWEEN WHICH DISTANCES ARE MEASURED INDICATED THIS WAY               |  | CATTLE GUARD  |  |
| RAILROAD   |  | PROMINENT ELEVATION                                 |  |
| RAILROADS IN JUNCTURE  |  | STATE LINE  |  |
| TWO OR MORE TRACKS OF SEPARATELY OPERATED COMPANIES OR ADJACENT RIGHT-OF-WAY |  | COUNTY LINE   |  |
| RAILROAD CROSSINGS   |  | CONGRESSIONAL TOWNSHIP LINE                         |  |
| GRADE CROSSINGS  |  | FEDERAL AND STATE RESERVATION BOUNDARY LINE         |  |
| RAILROAD ABOVE   |  | MONUMENT (SMALL)                                    |  |
| RAILROAD BELOW   |  | COUNTY SEAT   |  |
|  |  | OTHER CITIES AND VILLAGES                           |  |
| AIRPORT WITH SURFACED RUNWAYS  |  | UNINCORPORATED VILLAGE OR AREA OF CONGESTED CULTURE |  |
|  |  | INCORPORATED CITY OR VILLAGE                        |  |
| MILITARY FIELD   |  | (FIGURES INDICATED 1990 POPULATION)                 |  |
| AIRPORT, COMPLETE FACILITIES   |  |   |  |
| COMMERCIAL OR MUNICIPAL  |  |   |  |
| ARMBEL LIMITED FACILITIES  |  |   |  |
| LANDING AREA OR STRIP, INCLUDING PRIVATE AIR FIELDS                          |  |   |  |
| ARRAY LIGHT BEACON (GENERAL)   |  |   |  |

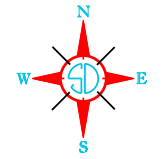

GENERAL HIGHWAY MAP  
SOUTH HALF  
**DEWEY COUNTY**  
SOUTH DAKOTA

prepared by the  
SOUTH DAKOTA DEPARTMENT OF TRANSPORTATION  
in cooperation with the  
U.S. DEPARTMENT OF TRANSPORTATION  
FEDERAL HIGHWAY ADMINISTRATION

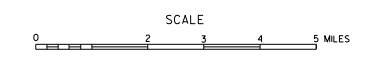

2017

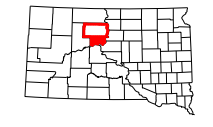

UNIVERSAL TRANSVERSE MERCATOR PROJECTION

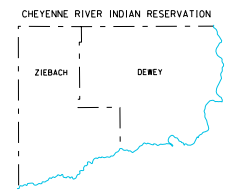

MAP PRODUCED BY  
CARTOGRAPHIC SECTION  
SOUTH DAKOTA DEPARTMENT OF TRANSPORTATION

RESTRICTION OF LIABILITY: The South Dakota Department of Transportation makes no claim, promise or guarantee about the accuracy, completeness or timeliness of the data and expressly disclaims liability for any and all omissions or errors of content. No warranty of any kind, implied, expressed or otherwise, including but not limited to the warranties of non-infringement of third party rights, title, merchantability and fitness for a particular purpose is given with respect to this data.

COPIES OF THIS MAP ARE AVAILABLE FOR PUBLIC USE AT A NOMINAL COST  
S. D. Department of Transportation  
Map Sales - - Ph. (605) 773-3249  
Pierre, South Dakota 57501