

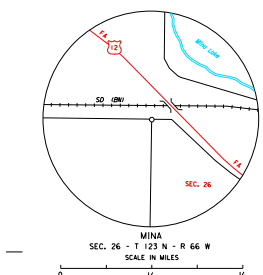

**LEGEND**

INTERSTATE HIGHWAY (FULL CONTROL OF ACCESS)		RAILROAD IN ADJACENT RIGHT-OF-WAY		RAILROAD CROSSINGS		STATE LINE		UNINCORPORATED VILLAGE OR AREA OF UNINCORPORATED VILLAGE OR AREA	
U.S. NUMBERED HIGHWAY		RAILROAD IN ADJACENT LEFT-OF-WAY		GRADE CROSSINGS		COUNTY LINE		INCORPORATED CITY OR VILLAGE	
STATE NUMBERED HIGHWAY		RAILROAD ABOVE		RAILROAD BELOW		CONGRESSIONAL TOWNSHIP LINE		FEDERAL RESERVED LAND	
FEDERAL AID HIGHWAY SYSTEM		RAILROAD BELOW		RAILROAD ABOVE		SECTION LINE		OTHER CITIES AND VILLAGES	
FEDERAL AID SECONDARY HIGHWAY SYSTEM		RAILROAD ABOVE		RAILROAD BELOW		FEDERAL AND STATE RESERVATION BOUNDARY LINE		COUNTY SEAT	
END OF FEDERAL AID RESERVATION ROUTE		RAILROAD BELOW		RAILROAD ABOVE		OTHER CITIES AND VILLAGES		UNINCORPORATED VILLAGE OR AREA OF UNINCORPORATED VILLAGE OR AREA	
PRIMITIVE ROAD		RAILROAD ABOVE		RAILROAD BELOW		OTHER CITIES AND VILLAGES		UNINCORPORATED VILLAGE OR AREA OF UNINCORPORATED VILLAGE OR AREA	
UNIMPROVED ROAD		RAILROAD BELOW		RAILROAD ABOVE		OTHER CITIES AND VILLAGES		UNINCORPORATED VILLAGE OR AREA OF UNINCORPORATED VILLAGE OR AREA	
GRAVEL OR STONE SURFACED ROAD		RAILROAD ABOVE		RAILROAD BELOW		OTHER CITIES AND VILLAGES		UNINCORPORATED VILLAGE OR AREA OF UNINCORPORATED VILLAGE OR AREA	
HARD SURFACED ROAD		RAILROAD BELOW		RAILROAD ABOVE		OTHER CITIES AND VILLAGES		UNINCORPORATED VILLAGE OR AREA OF UNINCORPORATED VILLAGE OR AREA	
DIVIDED HIGHWAY (LEFT EDGE/ROAD)		RAILROAD ABOVE		RAILROAD BELOW		OTHER CITIES AND VILLAGES		UNINCORPORATED VILLAGE OR AREA OF UNINCORPORATED VILLAGE OR AREA	
INTERCHANGE		RAILROAD BELOW		RAILROAD ABOVE		OTHER CITIES AND VILLAGES		UNINCORPORATED VILLAGE OR AREA OF UNINCORPORATED VILLAGE OR AREA	
HIGHWAY GRADE SEPARATION		RAILROAD ABOVE		RAILROAD BELOW		OTHER CITIES AND VILLAGES		UNINCORPORATED VILLAGE OR AREA OF UNINCORPORATED VILLAGE OR AREA	
POINTS BETWEEN ROAD DISTANCES ARE MEASURED IN FEET		RAILROAD BELOW		RAILROAD ABOVE		OTHER CITIES AND VILLAGES		UNINCORPORATED VILLAGE OR AREA OF UNINCORPORATED VILLAGE OR AREA	
ROADS WITH SURFACED RAMPWAYS		RAILROAD ABOVE		RAILROAD BELOW		OTHER CITIES AND VILLAGES		UNINCORPORATED VILLAGE OR AREA OF UNINCORPORATED VILLAGE OR AREA	
RAILROAD		RAILROAD BELOW		RAILROAD ABOVE		OTHER CITIES AND VILLAGES		UNINCORPORATED VILLAGE OR AREA OF UNINCORPORATED VILLAGE OR AREA	
RAILROAD CROSSINGS		RAILROAD ABOVE		RAILROAD BELOW		OTHER CITIES AND VILLAGES		UNINCORPORATED VILLAGE OR AREA OF UNINCORPORATED VILLAGE OR AREA	
RAILROAD ABOVE		RAILROAD BELOW		RAILROAD ABOVE		OTHER CITIES AND VILLAGES		UNINCORPORATED VILLAGE OR AREA OF UNINCORPORATED VILLAGE OR AREA	
RAILROAD BELOW		RAILROAD ABOVE		RAILROAD BELOW		OTHER CITIES AND VILLAGES		UNINCORPORATED VILLAGE OR AREA OF UNINCORPORATED VILLAGE OR AREA	
RAILROAD WITH SURFACED RAMPWAYS		RAILROAD ABOVE		RAILROAD BELOW		OTHER CITIES AND VILLAGES		UNINCORPORATED VILLAGE OR AREA OF UNINCORPORATED VILLAGE OR AREA	
MILITARY FIELD		RAILROAD BELOW		RAILROAD ABOVE		OTHER CITIES AND VILLAGES		UNINCORPORATED VILLAGE OR AREA OF UNINCORPORATED VILLAGE OR AREA	
ARREST, COMPLETE FACILITIES (COMMERCIAL OR MUNICIPAL)		RAILROAD ABOVE		RAILROAD BELOW		OTHER CITIES AND VILLAGES		UNINCORPORATED VILLAGE OR AREA OF UNINCORPORATED VILLAGE OR AREA	
ARREST, LIMITED FACILITIES		RAILROAD BELOW		RAILROAD ABOVE		OTHER CITIES AND VILLAGES		UNINCORPORATED VILLAGE OR AREA OF UNINCORPORATED VILLAGE OR AREA	
LANDING AREA OR STRIP		RAILROAD ABOVE		RAILROAD BELOW		OTHER CITIES AND VILLAGES		UNINCORPORATED VILLAGE OR AREA OF UNINCORPORATED VILLAGE OR AREA	
ROLLING PRIVATE AIR FIELDS		RAILROAD BELOW		RAILROAD ABOVE		OTHER CITIES AND VILLAGES		UNINCORPORATED VILLAGE OR AREA OF UNINCORPORATED VILLAGE OR AREA	
ARREST LIGHT BEACON FEDERAL		RAILROAD ABOVE		RAILROAD BELOW		OTHER CITIES AND VILLAGES		UNINCORPORATED VILLAGE OR AREA OF UNINCORPORATED VILLAGE OR AREA	

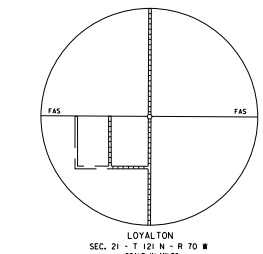

  
**GENERAL HIGHWAY MAP**  
**EDMUNDS COUNTY**  
**SOUTH DAKOTA**  
 prepared by the  
**SOUTH DAKOTA DEPARTMENT OF TRANSPORTATION**  
 in cooperation with the  
**U.S. DEPARTMENT OF TRANSPORTATION**  
**FEDERAL HIGHWAY ADMINISTRATION**  
 SCALE  
 0 1 2 3 4 5 MILES  
**2012**  
  
 UNIVERSAL TRANSVERSE MERCATOR PROJECTION

RESTRICTION OF LIABILITY: The South Dakota Department of Transportation makes no claim, promise or guarantee about the accuracy, completeness or timeliness of the data and information contained in this map. The user assumes all responsibility for any and all errors, omissions or inaccuracies in this map. The user agrees to hold the South Dakota Department of Transportation harmless from any and all claims, damages, losses or expenses, including reasonable attorneys' fees, that may be incurred by the user as a result of the use of this map.

COPIES OF THIS MAP ARE AVAILABLE FOR PUBLIC USE AT A NOMINAL COST. S.D. Department of Transportation, Map Sales - P.O. Box 400773, Pierre, South Dakota 57507