

LEGEND

INTERSTATE HIGHWAY (FULL CONTROL OF ACCESS)	STATE NAMED HIGHWAY	FEDERAL AID HIGHWAY SYSTEM	FEDERAL AID SECONDARY HIGHWAY SYSTEM	END OF FEDERAL AID DESIGNATED ROUTE	PRIMITIVE ROAD	UNIMPROVED ROAD	GRAVEL AND STONE SURFACE ROAD	HAND SURFACE ROAD	DIVIDED HIGHWAY (LIGHT CENTERLINE WALL)	INTERCHANGE	HIGHWAY GRADE SEPARATION	POINTS BETWEEN WHICH DISTANCES ARE MEASURED INDICATED THIS WAY	RAILROAD IN JUNCTION	RAILROAD IN ADJACENT RIGHT-OF-WAY	RAILROAD CROSSINGS	RAILROAD ABOVE	RAILROAD BELOW	AIRPORT WITH SURFACED RUNWAYS	MILITARY FIELD	ARMORY, COMPLETE FACILITIES (COMMERCIAL OR MUNICIPAL)	ARMORY, LIMITED FACILITIES	LANDING AREA OR STRIP, INCLUDING PRIVATE AIR FIELDS	AREAS LIGHT BEACON (GENERAL)	
IR	SH	FA	FS	ED	PR	UR	GS	HS	DH	IC	HGS	PD	IRJ	IRAW	IRAB	IR	IR	IR	IR	IR	IR	IR	IR	IR

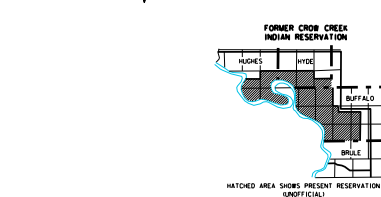

GENERAL HIGHWAY MAP
HAND COUNTY
SOUTH DAKOTA

prepared by the
 SOUTH DAKOTA DEPARTMENT OF TRANSPORTATION
 in cooperation with the
 U.S. DEPARTMENT OF TRANSPORTATION
 FEDERAL HIGHWAY ADMINISTRATION

SCALE
 0 1 2 3 4 5 MILES

2017

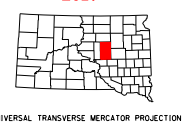

UNIVERSAL TRANSVERSE MERCATOR PROJECTION

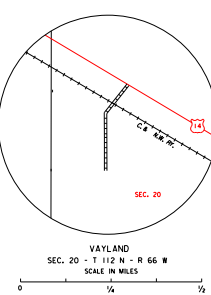
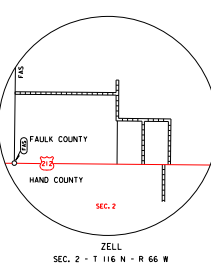

RESTRICTION OF LIABILITY: The South Dakota Department of Transportation makes no claim, promise or guarantee about the accuracy, timeliness, or completeness of the data contained in this map. The Department of Transportation and its employees, agents, contractors, or other parties shall not be held liable for any damages, including consequential damages, arising from the use of this map. The Department of Transportation makes no claim, promise or guarantee about the accuracy, timeliness, or completeness of the data contained in this map.

COPIES OF THIS MAP ARE AVAILABLE FOR PUBLIC USE AT A NOMINAL COST
 S.D. Department of Transportation
 Map Sales - P.O. Box 773, 5049
 Pierre, South Dakota 57501