

LEGEND

INTERSTATE HIGHWAY (FULL CONTROL OF ACCESS)	UNINCORPORATED VILLAGE OR AREA OF CONGESTED CULTURE
U.S. NUMBERED HIGHWAY	INCORPORATED CITY OR VILLAGE (FIGURES INDICATE 1990 POPULATION)
STATE NUMBERED HIGHWAY	FOREST RANGER STATION
PRIVATE ROAD	BATING BEACH OR SWIMMING POOL
UNIMPROVED ROAD	PLAYGROUND, BALL FIELD, ETC.
GRADED AND DRAINED ROAD	CAMP SITE, NO PERMANENCE
GRAVEL OR STONE SURFACED ROAD	POND OR POND
ROAD SURFACED ROAD	SCENE SITE
DRAINED HIGHWAY (WITH FRESHWATER ROAD)	TOURIST COURT OR MOTEL
INTERCHANGE	CAMP OR LODGE
HIGHWAY GRADE SEPARATION	FISH HATCHERY
POINTS BETWEEN WHICH DISTANCES ARE MEASURED INDICATED THIS	REST AREA
RAILROAD	GOLF COURSE OR COUNTRY CLUB
RAILROADS IN JUNCTURE POSITION	MANAGEMENT HALL OF PARK
TWO OR MORE TRACKS OF SEPARATELY OPERATED COMPANIES ON ADJACENT RIGHT-OF-WAY	SMALL PARK (SP - STATE, BP - BAYSIDE PARK, MP - MUNICIPAL PARK)
RAILROAD CROSSINGS	FARMLAND, RACE COURSE, SPEEDWAY
RAILROAD ABOVE	DRIVE - IN THEATRE
RAILROAD BELOW	FARM UNIT
RAILROAD BELOW	DWELLING (OTHER THAN FARM)
AIRPORT WITH SURFACED RUNWAYS	ROW OR GROUPS OF DWELLINGS CLOSELY SPACED
MILITARY FIELD	DWELLING, BUSINESS, AND FILING STATION
AIRPORT, COMPLETE FACILITIES (COMMERCIAL OR MUNICIPAL)	DWELLING, BUSINESS, FILING STATION, AND POST OFFICE
AIRFIELD, LIMITED FACILITIES	STATE POST OF ENTRY OR BIODI STATION
LANDING AREA OR STRIP	SEASONAL OR SUMMER COLONY DWELLING
INCLUDING PRIVATE AIR FIELDS	SEASONAL DWELLINGS CLOSELY SPACED
ARMY LIGHT BEACON (GENERAL)	FARMER - OTHER RELATED INSTITUTION
ARMY LIGHT BEACON (GENERAL)	CEMETERY
ARMY LIGHT BEACON (GENERAL)	CORPOR WITH CEMETARY ADJACENT
NARROW STREAM	STONE OR SMALL BUSINESS ESTABLISHMENT
WIDE STREAM (INDEPENDENT NAVIGATION)	FACTORY OR INDUSTRIAL PLANT
DRAINAGE DITCH (SMALL)	BUSINESS AND FILING STATION
IRIGATION DITCH	BUSINESS AND POST OFFICE
RESERVOIR, POND OR LAKE	FILING STATION
RESERVOIR, WITH DAM	RAILROAD
DAM	RAILROAD
WASH OR SWAMP LAND	RAILROAD
DOCK, PIER, OR LANDING	RAILROAD
HIGHWAY BRIDGE (OVER 30 FT. IN LENGTH)	RAILROAD
HIGHWAY BRIDGE CLOSELY SPACED	RAILROAD
STEEL TRUSS BRIDGE (LARGE)	RAILROAD
CATTLEWATER BRIDGE	RAILROAD
FORD - ROAD ESTABLISHED	RAILROAD
CONCRETE FORD	RAILROAD
CAUSEWAY	RAILROAD
CATTLE GUARD	RAILROAD
PROMONT ELEVATION	RAILROAD
STATE LINE	RAILROAD
COUNTY LINE	RAILROAD
CONGRESSIONAL TOWNSHIP LINE (WITH CALL LETTERS)	RAILROAD
SECTION LINE	RAILROAD
FEDERAL AND STATE RESERVATION BOUNDARY LINE	RAILROAD
MONUMENT (SMALL)	RAILROAD
COUNTY SEAL	RAILROAD
OTHER CITIES AND VILLAGES	RAILROAD

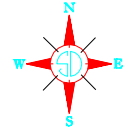
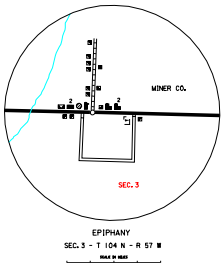

GENERAL HIGHWAY MAP
HANSON COUNTY
 SOUTH DAKOTA

prepared by the
 SOUTH DAKOTA DEPARTMENT OF TRANSPORTATION
 in cooperation with the
 U.S. DEPARTMENT OF TRANSPORTATION
 FEDERAL HIGHWAY ADMINISTRATION

SCALE
 0 1 2 3 4 5 MILES

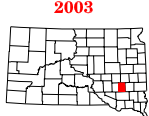

UNIVERSAL TRANSVERSE MERCATOR PROJECTION

COPIES OF THIS MAP ARE AVAILABLE FOR PUBLIC USE AT A NOMINAL COST
 S.D. Department of Transportation
 Map Scale - 1" = 100,000' (1:100,000)
 Plan No. SD-88-05