

LEGEND

INTERSTATE HIGHWAY (FULL CONTROL OF ACCESS)		UNINCORPORATED VILLAGE OR AREA OF CONGESTED CULTURE	
U.S. NUMBERED HIGHWAY		INCORPORATED CITY OR VILLAGE (FIGURES INDICATED 1990 POPULATION)	
STATE NUMBERED HIGHWAY		FOREST RANGER STATION	
PRIMITIVE ROAD		BATHING BEACH OR SWIMMING POOL	
UNIMPROVED ROAD		PLAYGROUND, BALL FIELD, ETC.	
GRAVEL AND GRADED ROAD		CAMP SITE, NO PERMANENCE	
GRAVEL OR STONE SURFACED ROAD		PICNIC GROUND	
HARD SURFACED ROAD		SCENE SITE	
DIVIDED HIGHWAY (WITH FRONTAGE ROAD)		TOURIST COURT OR MOTEL	
INTERCHANGE		CAMP OR LODGE	
HIGHWAY GRADE SEPARATION		FISH HATCHERY	
POINTS BETWEEN WHICH DISTANCES ARE MEASURED INDICATED THUS		REST AREA	
RAILROAD		GOLF COURSE OR COUNTRY CLUB	
RAILROADS IN JUNCTAPOSITION		AMUSEMENT HALL OR PARK	
TWO OR MORE TRACKS OF SEPARATELY OPERATED COMPANIES ON ADJACENT RIGHT-OF-WAY		SMALL PARK (SP - STATE, MP - WAYSIDE PARK, NP - MUNICIPAL PARK)	
RAILROAD CROSSINGS		FARGROUND, RACE COURSE, SPEEDWAY	
GRADE CROSSINGS		DRIVE-IN THEATRE	
RAILROAD ABOVE		FARM LINT	
RAILROAD BELOW		DWELLING (OTHER THAN FARM)	
AIRPORT WITH SURFACED RUNWAYS		ROW OR GROUPS OF DWELLINGS CLOSELY SPACED	
MILITARY FIELD		COMBINED DWELLING AND STORE OR SMALL BUSINESS	
ARPORT, COMPLETE FACILITIES (COMMERCIAL OR MUNICIPAL)		DWELLING, BUSINESS, AND FILLING STATION	
ARFIELD, LIMITED FACILITIES		DWELLING, BUSINESS, FILLING STATION, AND POST OFFICE	
LANDING AREA OR STRIP (INCLUDING PRIVATE AIR FIELDS)		STATE PORT OF ENTRY OR WEIGH STATION	
AIRWAY LIGHT BEACON (GENERAL)		SEASONAL OR SUMMER COLONY DWELLING	
NARROW STREAM (INTERMITTENT NAVIGATION)		SEASONAL DWELLINGS CLOSELY SPACED	
WIDE STREAM (INTERMITTENT NAVIGATION)		CHURCH - OTHER RELIGIOUS INSTITUTION	
DRAINAGE DITCH (MAIN)		CENETARY	
IRRIGATION DITCH		CHURCH WITH CENETARY ADJACENT	
RESERVOIR, POND OR LAKE		STORE OR SMALL BUSINESS ESTABLISHMENT	
RESERVOIR WITH DAM		FACTORY OR INDUSTRIAL PLANT	
DAM		BUSINESS AND FILLING STATION	
MARSH OR SWAMP LAND		BUSINESS AND POST OFFICE	
DOCK, PER, OR LANDING		FILLING STATION	
HIGHWAY BRIDGE (OVER 20 FT. IN LENGTH)		MINE	
HIGHWAY BRIDGES CLOSELY SPACED		BULK PLANT	
STEEL TRUSS BRIDGE LARGE		GAUGING OR PUMPING STATION (GENERAL)	
CANTILEVER BRIDGE		STOCK YARD - LOADING PEN OR CORRAL	
FORD - ROAD ESTABLISHED		GRAVEL PIT	
CONCRETE FORD		GRAIN ELEVATOR	
CAUSEWAY		WAREHOUSE (GENERAL) GOV'T. ADD US OR STATE	
CATTLE GUARD		NURSERY	
PROMINENT ELEVATION		SCHOOLHOUSE	
STATE LINE		CONSOLIDATED OR LARGE SCHOOL	
COUNTY LINE		OTHER EDUCATIONAL INSTITUTION	
CONGRESSIONAL TOWNSHIP LINE		TOWNHALL, GRANGE, OR COMMUNITY HALL	
SECTION LINE		ADMINISTRATION BUILDING	
FEDERAL AND STATE RESERVATION BOUNDARY LINE		POST OFFICE	
MONUMENT (SMALL)		HIGHWAY GARAGE (COUNTY, STATE OR FEDERAL)	
COUNTY SEAT		WATER SUPPLY STAND PIPE OR TANK	
OTHER CITIES AND VILLAGES		COMMUNICATION TOWER - TELEPHONE, REA ETC.	
		POWER SUBSTATION	
		RADIO OR TV STATION (WITH CALL LETTERS)	
		RADIO RANGE STATION	
		GARAGE OR RUBBISH DUMP	
		SEWAGE DISPOSAL PLANT	
		TRIANGULATION STATION	
		LOCATION OF CULTURE WHERE MAP SCALE DOES NOT PERMIT PLACING OF SYMBOL	

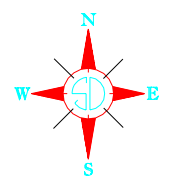
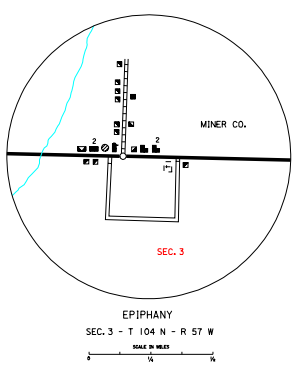

GENERAL HIGHWAY MAP HANSON COUNTY SOUTH DAKOTA

prepared by the
SOUTH DAKOTA DEPARTMENT OF TRANSPORTATION
in cooperation with the
U.S. DEPARTMENT OF TRANSPORTATION
FEDERAL HIGHWAY ADMINISTRATION

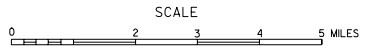

2006



UNIVERSAL TRANSVERSE MERCATOR PROJECTION

COPIES OF THIS MAP ARE AVAILABLE FOR PUBLIC USE AT A NOMINAL COST
S. D. Department of Transportation
Map Sales -- PH 1055/773 3249
Pierre, South Dakota 57501