

POTATO CREEK
SEC. 17 - T. 41 N. - R. 39 W.
SCALE IN MILES

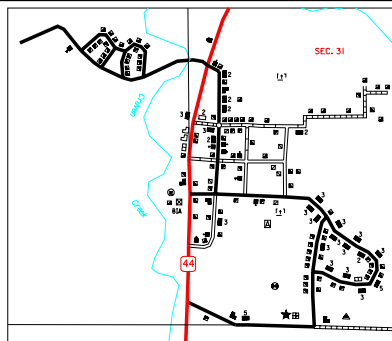

WANBLEE
SEC. 31 - T. 42 N. - R. 36 W.
SCALE IN MILES

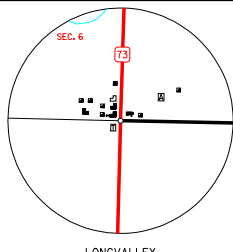

LONGVALLEY
SEC. 6 - T. 40 N. - R. 35 W.
SCALE IN MILES

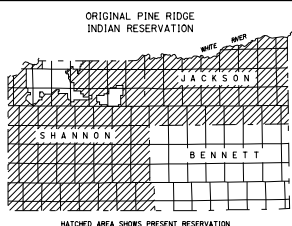

HATCHED AREA SHOWS PRESENT RESERVATION (UNOFFICIAL)

LEGEND

INTERSTATE HIGHWAY (FULL CONTROL OF ACCESS)	UNINCORPORATED VILLAGE OR AREA OF CONGESTED COUNTRY
U.S. NUMBERED HIGHWAY	INCORPORATED CITY OR VILLAGE (FIGURES INDICATE 1990 POPULATION)
STATE NUMBERED HIGHWAY	POP. 2500
PRIMITIVE ROAD	FOREST RANGER STATION
UNIMPROVED ROAD	BATHING BEACH OR SWIMMING POOL
GRAVEL OR STONE SURFACED ROAD	PLAYGROUND, BALL FIELD, ETC.
HARD SURFACED ROAD	CAMP SITE, NO PERMANENCE
DIVIDED HIGHWAY (LEFT FRONTAGE ROAD)	PICNIC GROUNDS
INTERCHANGE	SCENIC SITE
HIGHWAY GRADE SEPARATION	TOURIST COURT OR MOTEL
POINTS BETWEEN WHICH DISTANCES ARE MEASURED INDICATED THIS	CAMP OR LODGE
RAILROAD	FISH HATCHERY
RAILROADS IN JUNCTURE	REST AREA
THEIR NAME TRACKS IF SEPARATELY OPERATED COMPANIES OR ADJACENT RIGHT-OF-WAY	GOLF COURSE OR COUNTRY CLUB
RAILROAD CROSSINGS	CAMP OR LODGE
RAILROAD ABOVE	SMALL PARK (SP - STATE, WP - WATSEDA PARK, MP - MUNICIPAL PARK)
RAILROAD BELOW	FARROWLAND, RACE COURSE, SPEEDWAY
DRIVE - IN THEATRE	DRIVE - IN THEATRE
FARM UNIT	NOT IN USE
DWELLING (OTHER THAN FARM)	NOT IN USE
ROW OR GROUPS OF DWELLINGS CLOSELY SPACED	NOT IN USE
COMBINED DWELLING AND STORE OR SMALL BUSINESS	NOT IN USE
DWELLING, BUSINESS, AND FILMING STATION	NOT IN USE
DWELLING, BUSINESS, FILING STATION, AND POST OFFICE	NOT IN USE
MILITARY FIELD	STATE PORT OF ENTRY OR NEIGH STATION
AIRPORT, COMPLETE FACILITIES (COMMERCIAL OR MUNICIPAL)	SEASONAL OR SUMMER COLONY DWELLING
AIRFIELD, LIMITED FACILITIES	SEASONAL DWELLINGS CLOSELY SPACED
LANDING AREA OR STRIP INCLUDING PRIVATE AIR FIELDS	CHURCH - OTHER RELIGIOUS INSTITUTION
AIRWAY LIGHT BEACON (GENERAL)	CEMETARY
CHURCH WITH CEMETARY ADJACENT	CHURCH WITH CEMETARY ADJACENT
STORE OR SMALL BUSINESS ESTABLISHMENT	STORE OR SMALL BUSINESS ESTABLISHMENT
FACTORY OR INDUSTRIAL PLANT	FACTORY OR INDUSTRIAL PLANT
BUSINESS AND FILING STATION	BUSINESS AND FILING STATION
BUSINESS AND POST OFFICE	BUSINESS AND POST OFFICE
FILING STATION	FILING STATION
MINE	MINE
DAM	DAM
CAULDRON OR PUMPING STATION (GENERAL)	CAULDRON OR PUMPING STATION (GENERAL)
STOCK YARD - LOADING PEN OR CORRAL	STOCK YARD - LOADING PEN OR CORRAL
GRAVEL PIT	GRAVEL PIT
GRAVEL ELEVATOR	GRAVEL ELEVATOR
WASHHOUSE (GENERAL) (OVN'T, ADD US OR STATE)	WASHHOUSE (GENERAL) (OVN'T, ADD US OR STATE)
NURSERY	NURSERY
SCHOOLHOUSE	SCHOOLHOUSE
CONSOLIDATED OR LARGE SCHOOL	CONSOLIDATED OR LARGE SCHOOL
OTHER EDUCATIONAL INSTITUTION	OTHER EDUCATIONAL INSTITUTION
TOWNHALL, CRANES, OR COMUNITY HALL	TOWNHALL, CRANES, OR COMUNITY HALL
ADMINISTRATION BUILDING	ADMINISTRATION BUILDING
POST OFFICE - COUNTY, STATE OR FEDERAL	POST OFFICE - COUNTY, STATE OR FEDERAL
WORKING GARAGE	WORKING GARAGE
WATER SUPPLY STAND PIPE OR TANK	WATER SUPPLY STAND PIPE OR TANK
COMMUNICATION TOWER - TELEPHONE, REA ETC.	COMMUNICATION TOWER - TELEPHONE, REA ETC.
POWER SUBSTATION	POWER SUBSTATION
RADIO OR TV STATION (WITH CALL LETTERS)	RADIO OR TV STATION (WITH CALL LETTERS)
RADIO RANGE STATION	RADIO RANGE STATION
GARAGE OR RUBBISH DUMP	GARAGE OR RUBBISH DUMP
SEWAGE DISPOSAL PLANT	SEWAGE DISPOSAL PLANT
TRANSMISSION STATION	TRANSMISSION STATION
COUNTY SEAT	COUNTY SEAT
LOCATION OF CULTURE WHERE MAP SCALE DOES NOT PERMIT PLACING OF SYMBOL	LOCATION OF CULTURE WHERE MAP SCALE DOES NOT PERMIT PLACING OF SYMBOL

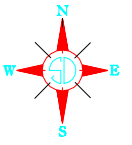
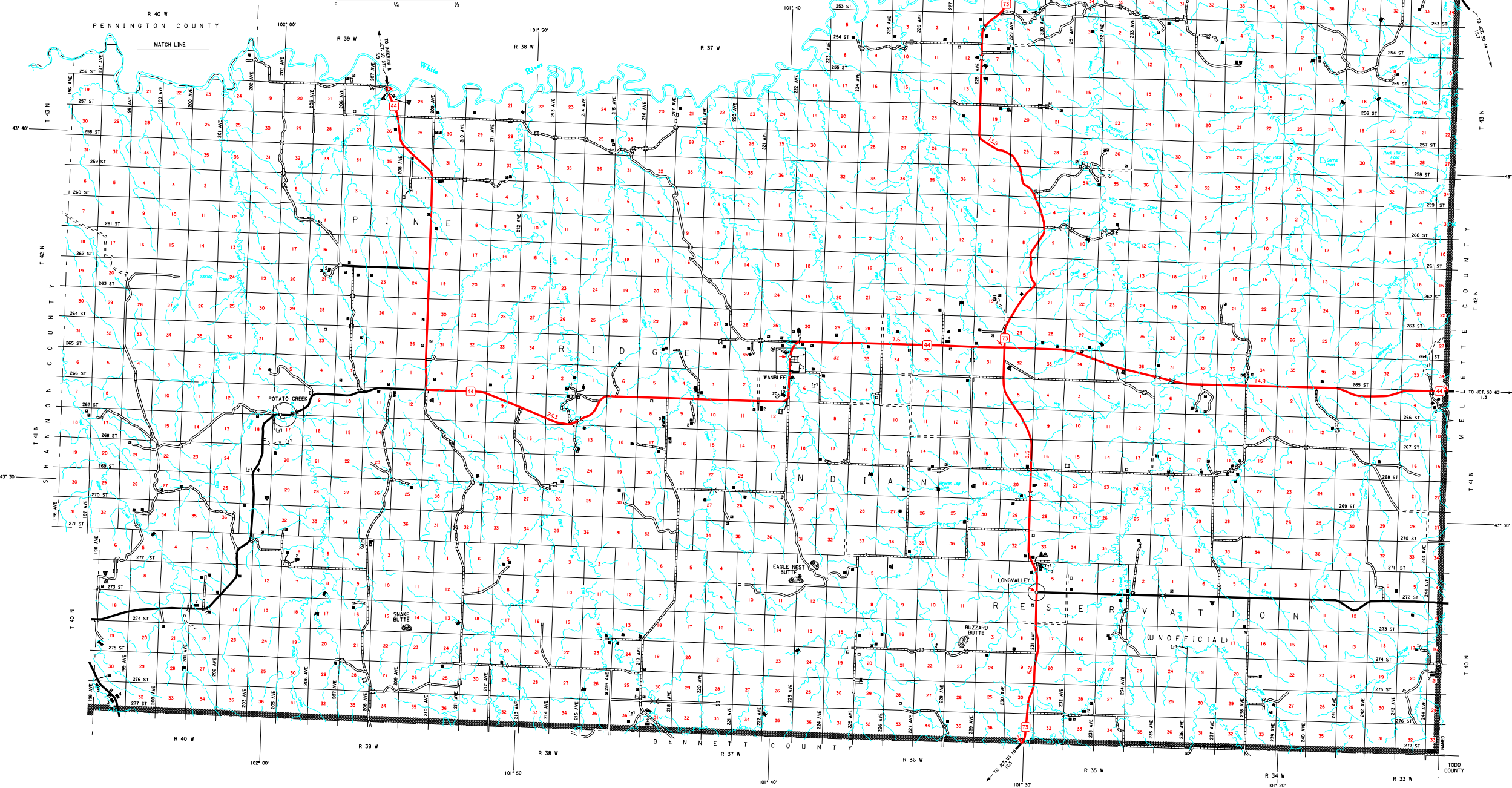

GENERAL HIGHWAY MAP
SOUTH HALF
JACKSON COUNTY
SOUTH DAKOTA

prepared by the
SOUTH DAKOTA DEPARTMENT OF TRANSPORTATION
in cooperation with the
U.S. DEPARTMENT OF TRANSPORTATION
FEDERAL HIGHWAY ADMINISTRATION

SCALE
0 1 2 3 4 5 MILES

2003



UNIVERSAL TRANSVERSE MERCATOR PROJECTION
U.S. and State numbered Highways
as of May 31, 1986

MAP PRODUCED BY
CARTOGRAPHIC SECTION
SOUTH DAKOTA
DEPARTMENT OF TRANSPORTATION

COPIES OF THIS MAP ARE AVAILABLE FOR PUBLIC USE AT A NOMINAL COST
S. D. Department of Transportation
Map Scale - 1:100,000 (1:100,000)
Planck, South Dakota 57501