

LEGEND

INTERSTATE HIGHWAY (FULL CONTROL OF ACCESS)		UNINCORPORATED VILLAGE OR AREA OF CONGESTED CULTURE	
U S NUMBERED HIGHWAY		INCORPORATED CITY OR VILLAGE (FIGURES INDICATED 1990 POPULATION)	
STATE NUMBERED HIGHWAY		FOREST RANGER STATION	
PRIMITIVE ROAD		BATHING BEACH OR SWIMMING POOL	
UNIMPROVED ROAD		PLAYGROUND, BALL FIELD, ETC.	
GRAVEL AND DRAINED ROAD		CAMP SITE, NO PERMANENCE	
GRAVEL OR STONE SURFACED ROAD		PICNIC GROUND	
HARD SURFACED ROAD		SCENIC SITE	
DIVIDED HIGHWAY (WITH FRONTAGE ROAD)		TOURIST COURT OR MOTEL	
INTERCHANGE		CAMP OR LODGE	
HIGHWAY GRADE SEPARATION		FISH HATCHERY	
POINTS BETWEEN WHICH DISTANCES ARE MEASURED INDICATED THIS		REST AREA	
RAILROAD		GOLF COURSE OR COUNTRY CLUB	
RAILROADS IN Juxtaposition		AMUSEMENT HALL OR PARK	
TWO OR MORE TRACKS OF SEPARATELY OPERATED COMPANIES ON ADJACENT RIGHT-OF-WAY		SMALL PARK (SP - STATE, WP - WAYSIDE PARK, MP - MUNICIPAL PARK)	
RAILROAD CROSSINGS		FAIRGROUND, RACE COURSE, SPEEDWAY	
GRADE CROSSINGS		DRIVE - IN THEATRE	
RAILROAD ABOVE		FARM UNIT	
RAILROAD BELOW		DEWELLING (OTHER THAN FARM)	
RAILROAD NOT IN USE		ROW OR GROUPS OF DWELLINGS CLOSELY SPACED	
RAILROAD WITH SURFACED RUNWAYS		COMBINED DWELLING AND STORE OR SMALL BUSINESS	
MILITARY FIELD		DWELLING, BUSINESS, AND FILLING STATION	
COMPLETE FACILITIES (COMMERCIAL OR MUNICIPAL)		STATE POINT OF ENTRY OR WOOD STATION	
ARPFIELD, LIMITED FACILITIES		SEASONAL OR SUMMER COLONY DWELLING	
LANDING AREA OR STRIP		SEASONAL DWELLINGS CLOSELY SPACED	
WELLING PRIVATE AIR FIELDS		CHURCH - OTHER RELIGIOUS INSTITUTION	
AIRWAY LIGHT BEACON (GENERAL)		CEMETERY	
NARROW STREAM (INTERMITTENT NAVIGATION)		CHURCH WITH CEMETARY ADJACENT	
WIDE STREAM (PERMANENT NAVIGATION)		STORE OR SMALL BUSINESS ESTABLISHMENT	
DRAINAGE DITCH (MAN)		FACTORY OR INDUSTRIAL PLANT	
IRRIGATION DITCH		BUSINESS AND FILLING STATION	
RESERVOIR, POND OR LAKE		BUSINESS AND POST OFFICE	
RESERVOIR, WITH DAM		FILLING STATION	
DAM		MINE	
MARSH OR SWAMP LAND		BULK PLANT	
DOCK, PIER, OR LANDING		CAUGING OR PUMPING STATION (GENERAL)	
HIGHWAY BRIDGE (OVER 20 FT. IN LENGTH)		STOCK YARD - LOADING PEN OR CORRAL	
HIGHWAY BRIDGES CLOSELY SPACED		GRAVEL PIT	
STEEL TRUSS BRIDGE LARGE		CRAN ELEVATOR	
CANTILEVER BRIDGE		WAREHOUSE (GENERAL) GOVT. ADD US OR STATE	
FORD - ROAD ESTABLISHED		NURSERY	
CAUSEWAY		SCHOOLHOUSE	
CATTLE GUARD		CONSOLIDATED OR LARGE SCHOOL	
PROMINENT ELEVATION		OTHER EDUCATIONAL INSTITUTION	
STATE LINE		TOWNHALL, GRANGE, OR COMMUNITY HALL	
COUNTY LINE		ADMINISTRATION BUILDING	
CONGRESSIONAL TOWNSHIP LINE		POST OFFICE	
SECTION LINE		HIGHWAY GARAGE (COUNTY, STATE OR FEDERAL)	
FEDERAL AND STATE RESERVATION BOUNDARY LINE		WATER SUPPLY STAND PIPE OR TANK	
MONUMENT (SMALL)		COMMUNICATION TOWER - TELEPHONE, REA ETC.	
COUNTY SEAT		POWER SUBSTATION	
OTHER CITIES AND VILLAGES		RADIO OR TV STATION (WITH CALL LETTERS)	
		SECTION LINE	
		FEDERAL AND STATE RESERVATION BOUNDARY LINE	
		MONUMENT (SMALL)	
		COUNTY SEAT	
		OTHER CITIES AND VILLAGES	
		LOCATION OF CULTURE WHERE MAP SCALE DOES NOT PERMIT PLACING OF SYMBOL	

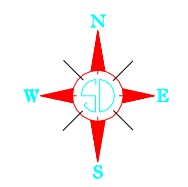
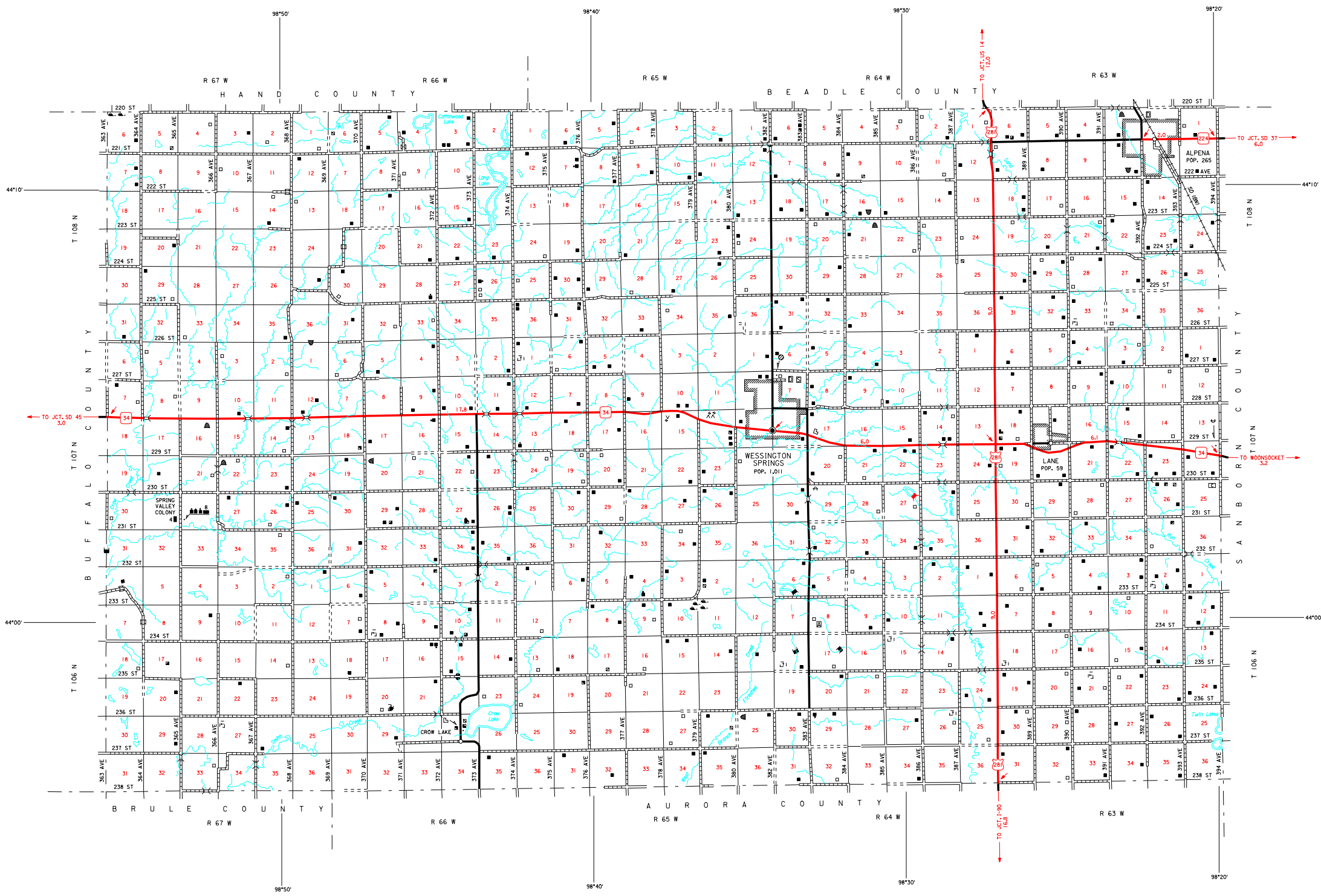

GENERAL HIGHWAY MAP  
**JERAULD COUNTY**  
**SOUTH DAKOTA**

prepared by the  
 SOUTH DAKOTA DEPARTMENT OF TRANSPORTATION  
 in cooperation with the  
 U.S. DEPARTMENT OF TRANSPORTATION  
 FEDERAL HIGHWAY ADMINISTRATION

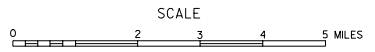

2006



UNIVERSAL TRANSVERSE MERCATOR PROJECTION