

LAWRENCE COUNTY SOUTH DAKOTA

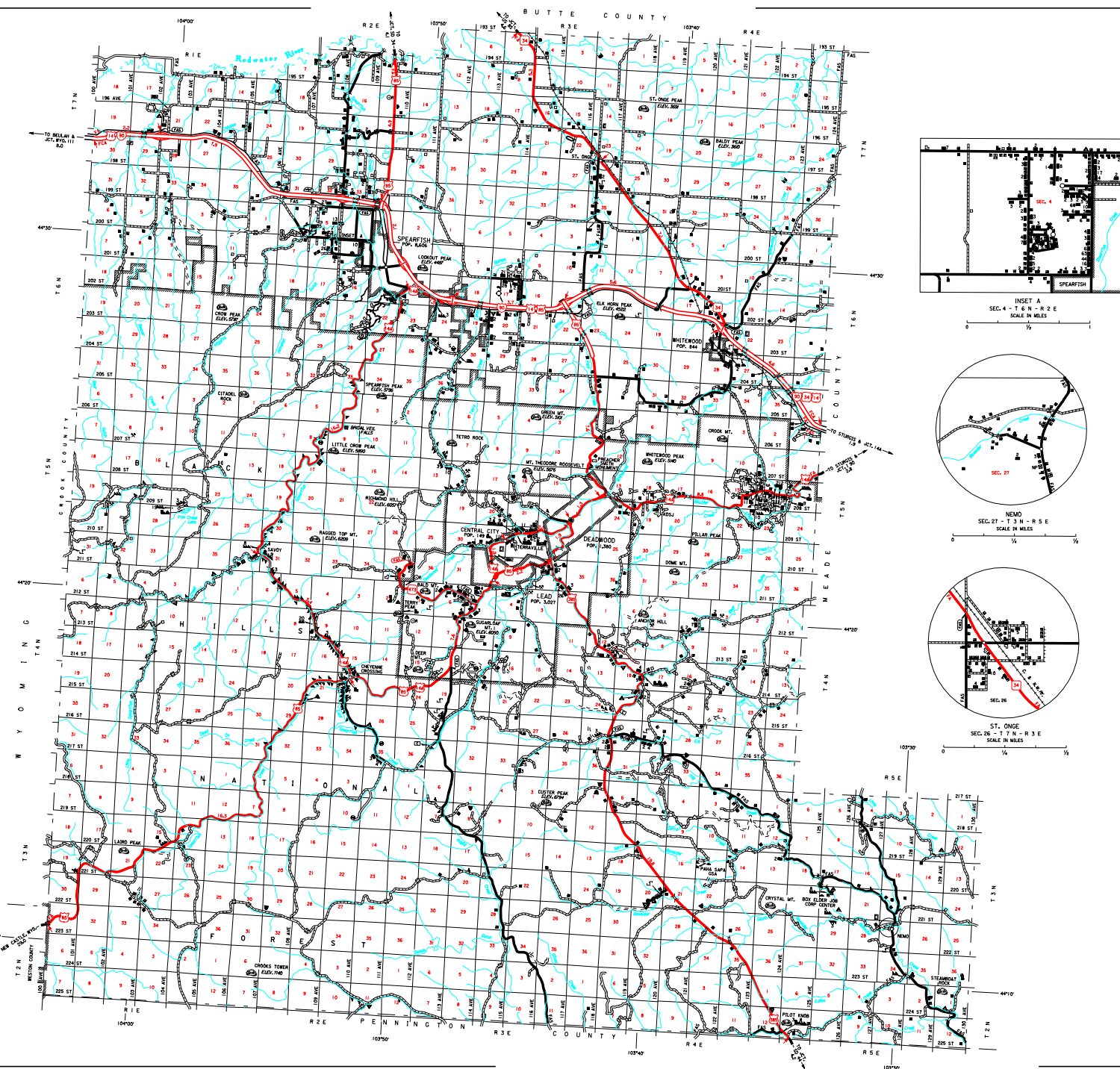

### LEGEND

UNDESIGNED HIGHWAY (FULL CONTROL OF ACCESS)		UNINCORPORATED VILLAGE OR AREA OF CONCENTRATED CULBERTS	
STATE NUMBERED HIGHWAY		INCORPORATED CITY OR VILLAGE (LINED AREA INDICATING 1970 POPULATION)	
FRONTAGE ROAD		FOREST MAINTENANCE STATION	
UNDESIGNED ROAD		BAYLETT BEACH OR SWAMPING POOL	
GRAVEL OR STONE SURFACED ROAD		PLASTERED WALL PIER, ETC.	
PAVED SURFACED ROAD		STATE PIERS OR BENTS OR BEACH STATION	
PAVED HIGHWAY (LETHAL FEEDBACK ROAD)		POLE FOUND	
INTERCHANGING		SOILS STATE	
HIGHWAY CROSS SEPARATION		TOILET OR CABIN OR HOTEL	
POINTS BETWEEN BRIDGE SPACINGS ARE MEASURED INDICATED THIS		CAMP OR LODGE	
RAILROAD		FEED HOUSE	
RAILROADS IN DISAPPOSITION		REST AREA	
COMPASSES IN ADJACENT QUARTERS OPERATED COMPASSES IN ADJACENT QUARTERS OF RAIL		SOIL CONTOUR OR COUNTRY CLUB	
RAILROAD CROSSING		ASSOCIATED WALL OR FENCE	
RAILROAD BRIDGE		SMALL PARK (SP - STATE, MP - WAYSIDE PARK, MP - MUNICIPAL PARK)	
RAILROAD BELOW		FARMHOUSE, WIDE CORNER, SHERMAN	
RAILROAD WITH SURFACED PARALLELS		ONE - IN THEATRE	
MILITARY FIELD		FARM UNIT	
APPROX. COMPLETE FIELDS (COMMERCIAL OR MUNICIPAL)		DOUBLE (OTHER THAN FARM)	
APPROX. LIMITED FACILITIES		ROD OR GROUPS OF BELLINGS CLOSELY SPACED	
LANDING AREA OR STAGE		CONCRETE BELLING AND STORE OF SMALL BELLINGS	
AREAS WITH BRACKEN (GENERAL)		BELLING, BUSINESS, AND PALMS STATION	
NARROW STREAM		BELLING, BUSINESS, AND PALMS STATION AND POST OFFICE	
ROCK STREAM (INDISTINCT NAVIGATION)		BELLING, BUSINESS, AND PALMS STATION	
DRAINAGE STATION (GENERAL)		SEASONAL OR TUMBER COUNTY DRAINAGE	
IRRIGATION DITCH		SEASONAL DRAINAGE CLOSELY SPACED	
RESERVOIR, POND OR LAKE		CHURCH - OTHER RELIGIOUS INSTITUTION	
RESERVOIR, WITH DAM		CHURCH	
DAM		CHURCH WITH CEMETERY ADJACENT	
MARK OF BERM LAND		STONE OR SMALL BUSINESS ESTABLISHMENT	
DOCK, PIER, OR LANDING		FACTORY OR INDUSTRIAL PLANT	
HIGHWAY BRIDGE (UNDER 20 FT. IN LENGTH)		STEEL BRIDGE	
HIGHWAY BRIDGES CLOSELY SPACED		STEEL BRIDGE - LANDING PIER OR CORNER	
STONE TRUSS BRIDGE LARGE		WATERWAY (GENERAL) 150 FT. AND UP ON STATE	
CANTILEVER BRIDGE		WATERWAY	
FORD - ROAD ESTABLISHED		CONSOLIDATED OR LAKE SCHOOL	
CONCRETE FORD		OTHER EDUCATIONAL INSTITUTION	
GASSTATION, WITH OR WITHOUT		TERRACE, GRASS, OR CONCRETE WALL	
GATTLER GARD		ADMINISTRATIVE BUILDING	
PROMONT ELEVATION		HIGHWAY GARAGE (COUNTY, STATE OR FEDERAL)	
STATE LINE		WATER SUPPLY STAGE PIPE OR TANK	
COUNTY LINE		CONGRESSIONAL TOWNSHIP - ELEVATION, SEA LEVEL	
CONGRESSIONAL TOWNSHIP LINE		POWER STATION	
SECTION LINE		RAILROAD STATION (WITH CALL LETTERS)	
FEDERAL AND STATE RESERVATION BOUNDARY LINE		RAILROAD OR TUMBER DAM	
MONUMENT (SMALL)		MONUMENT (GENERAL) 150 FT. AND UP	
COUNTY SEAT		TRANSMISSION STATION	
OTHER CITIES AND VILLAGES		LOCATION OF CULTURE BURN MAP SCALE DOES NOT PERMIT PLACING OF SYMBOL	

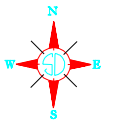
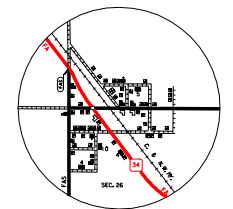
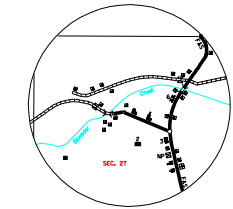
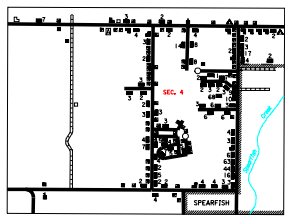

# GENERAL HIGHWAY MAP

# LAWRENCE COUNTY

## SOUTH DAKOTA

prepared by the  
SOUTH DAKOTA DEPARTMENT OF TRANSPORTATION  
in cooperation with the  
U.S. DEPARTMENT OF TRANSPORTATION  
FEDERAL HIGHWAY ADMINISTRATION

SCALE  
0 1 2 3 4 5 MILES

2003



UNIVERSAL TRANSVERSE MERCATOR PROJECTION  
U.S. and State numbered Highways and the Federal-Aid Primary and Federal-Aid Secondary systems as of May 31, 1986

COPIES OF THIS MAP ARE AVAILABLE FOR PUBLIC USE AT A NOMINAL COST  
S. D. Department of Transportation  
Map Scale - 1/4" = 10.0000772 2000  
Pierre, South Dakota 57500

LAWRENCE COUNTY SOUTH DAKOTA