

ALBERTA COUNTY LYMAN COUNTY SOUTH DAKOTA

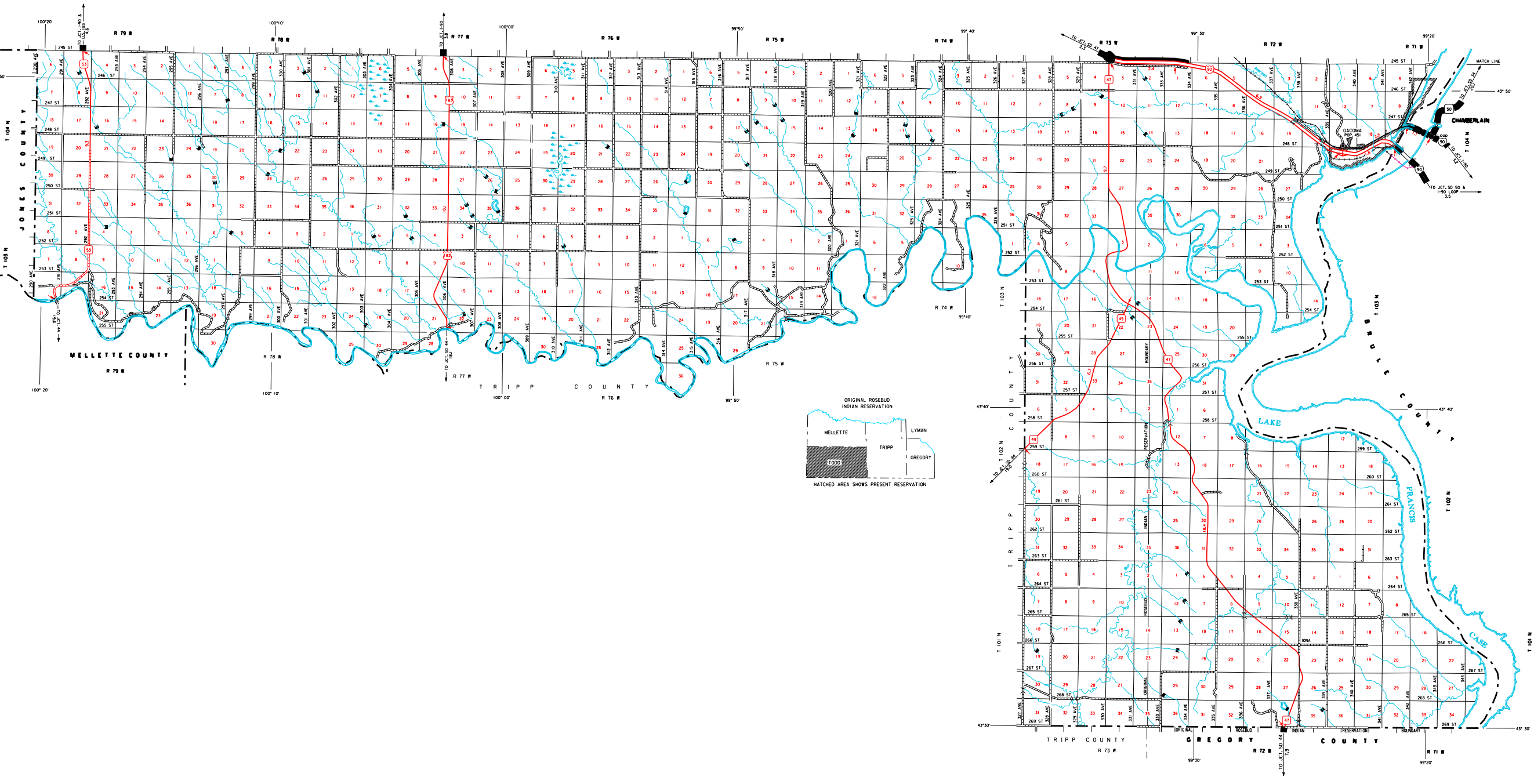

LEGEND

INTERSTATE HIGHWAY (FULL CONTROL OF ACCESS)	1-2	NARROW STREAM	Wavy line with arrows
U.S. NUMBERED HIGHWAY	1-2	WIDE STREAM (ENTIREMENT NAVIGATION)	Wavy line with arrows
STATE NUMBERED HIGHWAY	1-2	DRAINAGE DITCH (MAIN)	Wavy line with arrows
FEDERAL AID SECONDARY HIGHWAY SYSTEM	1-2	IRRIGATION DITCH	Wavy line with arrows
END OF FEDERAL AID DESIGNATED ROUTE	1-2	RESERVOIR, POND OR LAKE	Blue shaded area
		RESERVOIR, WITH DAM	Blue shaded area with dam symbol
		DAM	Dam symbol
		MARSH OR SWAMP LAND	Blue hatched area
PRIVATE ROAD	1-2	DOCK, PIER, OR LANDING	Blue hatched area
UNIMPROVED ROAD	1-2	HIGHWAY BRIDGE (OVER 20 FT. IN LENGTH)	Blue hatched area
GRADED AND DRAINED ROAD	1-2	HIGHWAY BRIDGE (CLOSELY SPACED)	Blue hatched area
GRAVEL OR STONE SURFACE ROAD	1-2	STEEL TRUSS BRIDGE LAKE	Blue hatched area
WIND SURFACE ROAD	1-2	CANTILEVER BRIDGE	Blue hatched area
DIVIDED HIGHWAY (LEFT FRONTAGE ROAD)	1-2	FORD - ROAD ESTABLISHED	Blue hatched area
INTERCHANGE	1-2	CONCRETE FORD	Blue hatched area
HIGHWAY GRADE SEPARATION	1-2	CAUSEWAY	Blue hatched area
POINTS BETWEEN WHICH DISTANCES ARE MEASURED INDICATED THIS WAY	1-2	CATTLE GUARD	Blue hatched area
RAILROAD	1-2	PROMINENT ELEVATION	Blue hatched area
RAILROAD IN EXTENSION	1-2	STATE LINE	Dashed line
TWO OR MORE TRACKS OF SEPARATELY OPERATED COMPANIES ON ADJACENT RIGHT-OF-WAY	1-2	COUNTY LINE	Dashed line
RAILROAD CROSSINGS	1-2	CONGRESSIONAL TOWNSHIP LINE	Dashed line
GRADE CROSSINGS	1-2	SECTION LINE	Dashed line
RAILROAD ABOVE	1-2	FEDERAL AND STATE RESERVATION BOUNDARY LINE	Dashed line
RAILROAD BELOW	1-2	COUNTY SEAL	Circle with star
		OTHER CITIES AND VILLAGES	Circle with star
		UNINCORPORATED VILLAGE OR AREA OF CONGESTED CULTURE	Circle with star
		INCORPORATED CITY OR VILLAGE (FIGURES INDICATED 1990 POPULATION)	Circle with star
		MILITARY FIELD	Circle with star
		AIRPORT, COMPLETE FACILITIES	Circle with star
		(COMMERCIAL OR MUNICIPAL)	Circle with star
		AIRFIELD, LIMITED FACILITIES	Circle with star
		LANDING AREA OR STRIP	Circle with star
		(INCLUDING PRIVATE AIR FIELDS)	Circle with star
		AIRWAY LIGHT BEACON (GENERAL)	Circle with star



GENERAL HIGHWAY MAP
SOUTH HALF
LYMAN COUNTY
SOUTH DAKOTA

prepared by the
SOUTH DAKOTA DEPARTMENT OF TRANSPORTATION
 in cooperation with the
U.S. DEPARTMENT OF TRANSPORTATION
FEDERAL HIGHWAY ADMINISTRATION

SCALE
 0 2 4 5 MILES

2017

UNIVERSAL TRANSVERSE MERCATOR PROJECTION

RESTRICTION OF LIABILITY: The South Dakota Department of Transportation makes no claim, warranty or guarantee of any kind in the publication of this map. The user assumes full responsibility for any and all errors or omissions in the data contained herein, and for any and all consequences thereof. The Department of Transportation is not liable for any and all damages, including but not limited to, the economic and non-economic damages, arising from the use of this map. The user's use of this map is at their own risk. No liability is given with respect to this data.

COPIES OF THIS MAP ARE AVAILABLE FOR PUBLIC USE AT A NOMINAL COST.
 S.D. Department of Transportation
 Map Sales - PO BOX 772 204E
 Pierre, South Dakota 57501

ALBERTA COUNTY LYMAN COUNTY SOUTH DAKOTA