

LEGEND

- INTERSTATE HIGHWAY (FULL CONTROL OF ACCESS)
- U.S. NUMBERED HIGHWAY
- STATE NUMBERED HIGHWAY
- PRIMITIVE ROAD
- UNIMPROVED ROAD
- GRAVEL AND DRAGGED ROAD
- GRAVEL OR STONE SURFACED ROAD
- HARD SURFACED ROAD
- SHOVED HIGHWAY (LITH. FOOTING ROAD)
- INTERCHANGE
- HIGHWAY GRADE SEPARATION
- POINTS BETWEEN WHICH DISTANCES ARE MEASURED INDICATED THUS
- RAILROADS
- RAILROADS IN JUNCTURATION
- TRUCK OR MORE TRUCKS OF SEPARATELY OPERATED COMPANIES IN ADJACENT RIGHT-OF-WAY
- RAILROAD CROSSINGS
- GRADE CROSSING
- RAILROAD ABOVE
- RAILROAD BELOW
- FARM UNIT
- DRILLING OTHER THAN FARM
- NEW OR GROUPS OF DRILLINGS CLOSELY SPACED
- COMBINED DRILLING AND STORE OR SMALL BUSINESS
- DRILLING, BUSINESS, AND FILING STATION
- DRILLING BUSINESS, FILING STATION, AND POST OFFICE
- STATE POINT OF ENTRY OR WEIGH STATION
- SEASONAL OR SUMMER COLONY DRILLING
- SEASONAL DRILLINGS CLOSELY SPACED
- CHECKER - OTHER RESIDUAL INSTITUTION
- CEMETARY
- CHURCH WITH CEMETARY ADJACENT
- STONE OR SMALL BUSINESS ESTABLISHMENT
- FACTORY OR INDUSTRIAL PLANT
- BUSINESS AND FILING STATION
- BUSINESS AND POST OFFICE
- FILING STATION
- DAW
- GAUGING ON PUMPING STATION (GENERAL)
- STOCK LAND - LANDING WITH CORRAL
- GRAVEL PIT
- GRAIN ELEVATOR
- HANDICAPED (GENERAL) SPORT AND USE ON STATE
- NURSERY
- SCHOOLHOUSE
- CONSOLIDATED OR LARGE SCHOOL
- OTHER EDUCATIONAL INSTITUTION
- TOWNHALL, GRANGE, OR COMMUNITY HALL
- ADMINISTRATIVE BUILDING
- POST OFFICE
- HIGHWAY GARAGE (COUNTY, STATE OR FEDERAL)
- BATTERY SUPPLY STAND PIPE OR TANK
- COMMUNICATION TOWER - TELEPHONE, R.F.A. ETC.
- POWER SUBSTATION
- RADIO OR TV STATION (WITH CALL LETTERS)
- RADIO FANED STATION
- GARAGE OR REPAIR SHED
- SEWAGE DISPOSAL PLANT
- TRANSMISSION STATION
- LOCATION OF COUNTY BUREAU MAP SCALE DOES NOT PERMIT PLACING OF SYMBOL
- OTHER CITIES AND VILLAGES

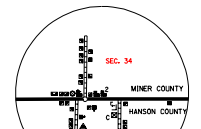

EPIPHANY SEC. 34 - T 105 N - R 57 W SCALE IN MILES

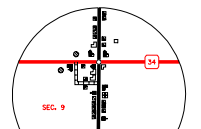

FEDORA SEC. 9 - T 106 N - R 58 W SCALE IN MILES

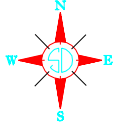

GENERAL HIGHWAY MAP MINER COUNTY SOUTH DAKOTA

prepared by the SOUTH DAKOTA DEPARTMENT OF TRANSPORTATION in cooperation with the U.S. DEPARTMENT OF TRANSPORTATION FEDERAL HIGHWAY ADMINISTRATION

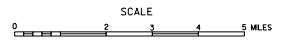

2003

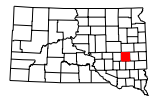

UNIVERSAL TRANSVERSE MERCATOR PROJECTION