

LYONS
SEC. 17 - T103N - R50W
SCALE IN MILES

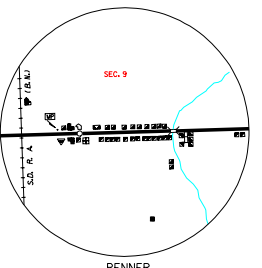

CORSON
SEC. 22 - T102N - R48W
SCALE IN MILES

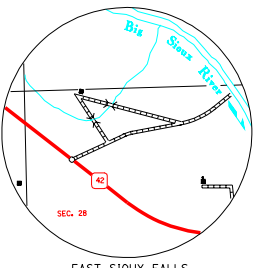

RENNER
SEC. 9 - T102N - R49W
SCALE IN MILES

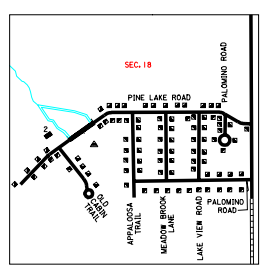

EAST SIOUX FALLS
SEC. 28 - T101N - R48W
SCALE IN MILES



PINE LAKE VIEW
SEC. 18 - T101N - R48W
SCALE IN MILES

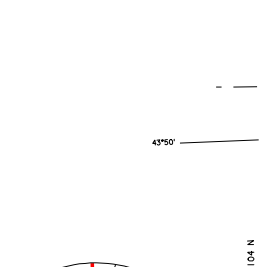

ROWENA
SEC. 26 - T101N - R48W
SCALE IN MILES

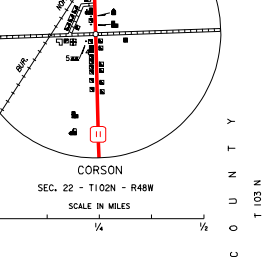

ROWENA
SEC. 26 - T101N - R48W
SCALE IN MILES

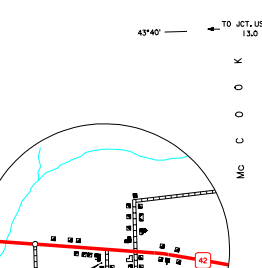

ROWENA
SEC. 26 - T101N - R48W
SCALE IN MILES

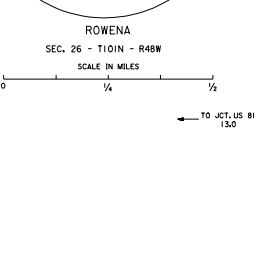

ROWENA
SEC. 26 - T101N - R48W
SCALE IN MILES



ROWENA
SEC. 26 - T101N - R48W
SCALE IN MILES

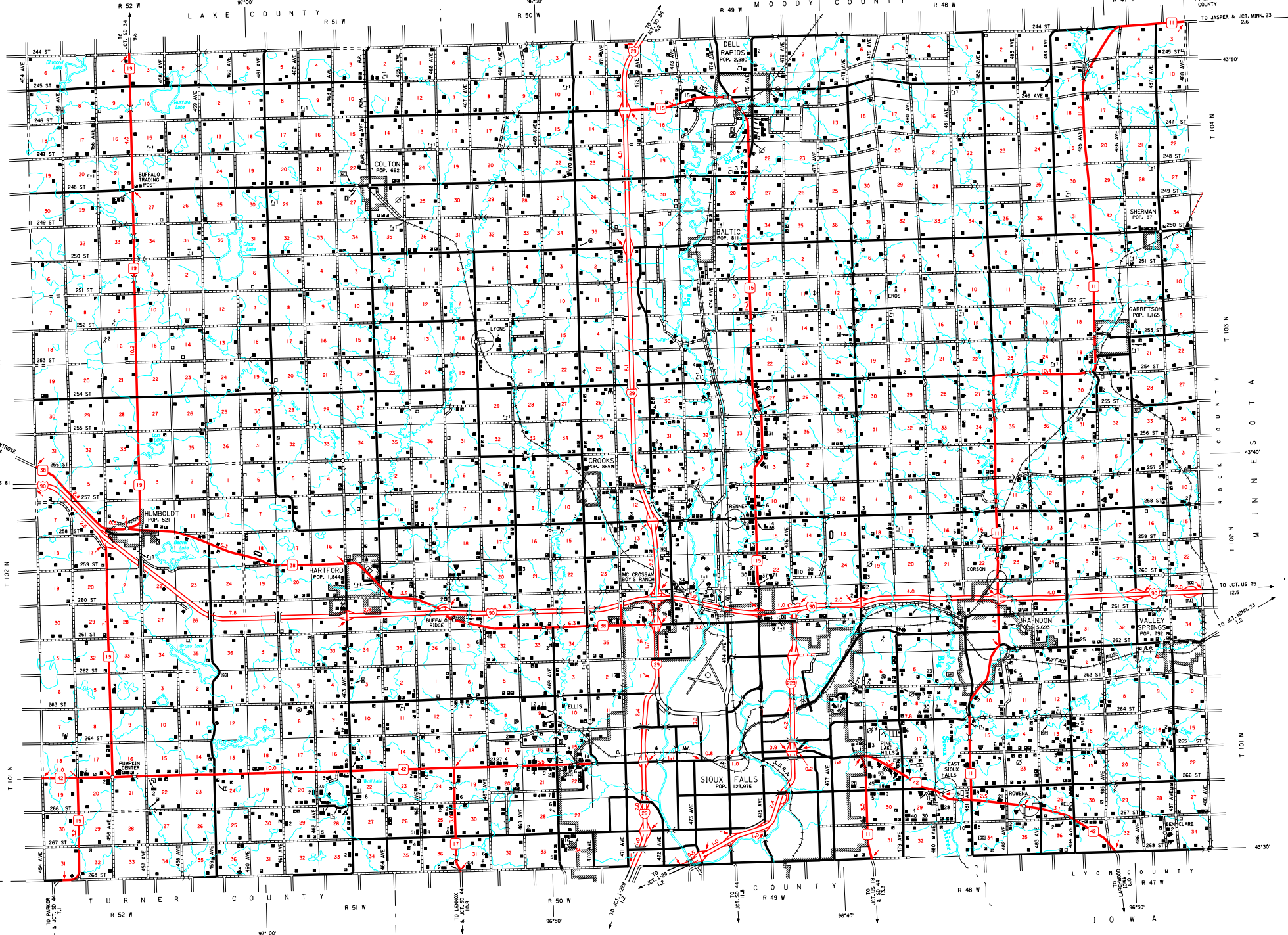

LEGEND

INTERSTATE HIGHWAY (FULL CONTROL OF ACCESS)	UNINCORPORATED VILLAGE OR AREA OF CONGESTED CATURE
U.S. NUMBERED HIGHWAY	INCORPORATED CITY OR VILLAGE (FIGURES INDICATE 1990 POPULATION)
STATE NUMBERED HIGHWAY	POP. 2500
PRIMITIVE ROAD	FOREST RANGER STATION
UNIMPROVED ROAD	BATHING BEACH OR SWIMMING POOL
GRAVEL OR STONE SURFACED ROAD	PLAYGROUND, BALL FIELD, ETC.
HARD SURFACED ROAD	CAMP SITE, NO PERMANENCE
DIVIDED HIGHWAY (WITH EDGEMOUNT ROAD)	PICNIC GROUND
INTERCHANGE	SCENIC SITE
HIGHWAY GRADE SEPARATION	TOURIST COURT OR MOTEL
POINTS BETWEEN WHICH DISTANCES ARE MEASURED INDICATED THIS	CAMP OR LODGE
RAILROAD	FISH HATCHERY
RAILROADS IN JUNCTATION	REST AREA
TWO OR MORE TRACKS OF SEPARATELY OPERATED COMPANIES ON ADJACENT RIGHT-OF-WAY	GOLF COURSE OR COUNTRY CLUB
RAILROAD CROSSINGS	AMUSEMENT HALL OR PARK
GRADE CROSSINGS	SMALL PARK (SP - STATE, WP - WARDEN PARK, MP - MUNICIPAL PARK)
RAILROAD ABOVE	FABRICATING, RACE COURSE, SPEEDWAY
RAILROAD BELOW	DRIVE-IN THEATRE
AIRPORT WITH SURFACED RUNWAYS	FARM LINT
MILITARY FIELD	DWELLING (OTHER THAN FARM)
AIRPORT, COMPLETE FACILITIES (COMMERCIAL OR MUNICIPAL)	ROW OR GROUPS OF DWELLINGS CLOSELY SPACED
SEASONAL OR SUMMER COLONY DWELLING	COMBINED DWELLING AND STORE OR SMALL BUSINESS
LANDING AREA OR STRIP INCLUDING PRIVATE AIR FIELDS	DWELLING, BUSINESS, AND FILLING STATION
ARMY LIGHT BEACON (GENERAL)	DWELLING, BUSINESS, FILLING STATION, AND POST OFFICE
NARROW STREAM	STATE PORT OF ENTRY OR WOOD STATION
WIDE STREAM (INTERMITTENT NAVIGATION)	SEASONAL DWELLINGS CLOSELY SPACED
DRAINAGE DITCH (WATER)	CHURCH - OTHER RELIGIOUS INSTITUTION
IRRIGATION DITCH	CEMETARY
RESERVOIR, POND OR LAKE	CHURCH WITH CEMETARY ADJACENT
RESERVOIR, WITH DAM	STORE OR SMALL BUSINESS ESTABLISHMENT
MINE	FACTORY OR INDUSTRIAL PLANT
DAM	BUSINESS AND FILLING STATION
CAULDRON OR PUMING STATION (GENERAL)	BUSINESS AND POST OFFICE
MARSH OR SWAMP LAND	FILLING STATION
DOCK, PIER, OR LANDING	MINE
HIGHWAY BRIDGE (OVER 20 FT. IN LENGTH)	BULK PLANT
HIGHWAY BRIDGE CLOSELY SPACED	CAULDRON OR PUMING STATION (GENERAL)
STEEL TRUSS BRIDGE LARGE	STOCK YARD - LOADING PIER OR CORRAL
CAULDRON BRIDGE	GRAVEL PIT
FORD - ROAD ESTABLISHED	GRAN ELEVATOR
CONCRETE FORD	BARRICADE (GENERAL) GOVT. AD US OR STATE
CAUSEWAY	NEARBY
CATTLE GUARD	SCHOOLHOUSE
PROMINENT ELEVATION	CONSOLIDATED OR LARGE SCHOOL
STATE LINE	OTHER EDUCATIONAL INSTITUTION
COUNTY LINE	TOWNHALL, GRANGE, OR COMMUNITY HALL
CONGRESSIONAL TOWNSHIP LINE	ADMINISTRATION BUILDING
SECTION LINE	POST OFFICE
FEDERAL AND STATE RESERVATION BOUNDARY LINE	HIGHWAY GARAGE (COUNTY, STATE OR FEDERAL)
MONUMENT (SMALL)	WATER SUPPLY STAND PIPE OR TANK
COUNTY SEAT	COMMUNICATION TOWER - TELEPHONE, REA ETC.
OTHER CITIES AND VILLAGES	POWER SUBSTATION
	RADIO STATION (WITH CALL LETTERS)
	RADIO RANGE STATION
	GARAGE OR RUBBER DUMP
	SEWAGE DISPOSAL PLANT
	TRANSLATION STATION
	LOCATION OF CULTURE WHERE MAP SCALE DOES NOT PERMIT PLACING OF SYMBOL

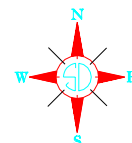

GENERAL HIGHWAY MAP MINNEHAHA COUNTY SOUTH DAKOTA

prepared by the
SOUTH DAKOTA DEPARTMENT OF TRANSPORTATION
in cooperation with the
U.S. DEPARTMENT OF TRANSPORTATION
FEDERAL HIGHWAY ADMINISTRATION

SCALE
0 1 2 3 4 5 MILES

2006



UNIVERSAL TRANSVERSE MERCATOR PROJECTION