

LEGEND

| | | | |
|--|--|--|--|
| INTERSTATE HIGHWAY (FULL CONTROL OF ACCESS) | | NARROW STREAM | |
| U.S. NUMBERED HIGHWAY | | WIDE STREAM (INTERNATIONAL NAVIGATION) | |
| STATE NUMBERED HIGHWAY | | DRAINAGE DITCH (WATER) | |
| FEDERAL AID HIGHWAY SYSTEM | | IRRIGATION DITCH | |
| FEDERAL AID SECONDARY HIGHWAY SYSTEM | | RESERVOIR, POND OR LAKE | |
| END OF FEDERAL AID DESIGNATED ROUTE | | RESERVOIR, POND OR LAKE WITH DAM | |
| | | DAM | |
| | | WASH OR CAMP LAND | |
| PRIMITIVE ROAD | | DOCK, PIER, OR LANDING | |
| UNIMPROVED ROAD | | HIGHWAY BRIDGE (OVER 20 FT. IN LENGTH) | |
| GRAVEL AND STRAND ROAD | | BRIDGE BRIDGES CLOSELY SPACED | |
| GRAVEL OR STONE SURFACED ROAD | | STEEL TRUSS BRIDGE LARGE | |
| HARD SURFACED ROAD | | CANTILEVER BRIDGE | |
| DISHED HIGHWAY (LEFT-EDGED LAKE ROAD) | | FORD - ROAD ESTABLISHED | |
| INTERCHANGE | | CONCRETE FORD | |
| HIGHWAY GRADE SEPARATION | | CAUSEWAY | |
| POINTS BETWEEN WHICH DISTANCES ARE MEASURED INDICATED THIS WAY | | CATTLE GUARD | |
| RAILROAD | | PROMONT ELEVATION | |
| RAILROAD IN JUNCTION | | STATE LINE | |
| TWO OR MORE TRACKS OF SEPARATELY OPERATED COMPANIES ON ADJACENT RIGHT-OF-WAY | | COUNTY LINE | |
| RAILROAD CROSSINGS | | CONGRESSIONAL TOWNSHIP LINE | |
| GRADE CROSSING | | SECTION LINE | |
| RAILROAD ABOVE | | FEDERAL AND STATE RESERVATION BOUNDARY LINE | |
| RAILROAD BELOW | | MONUMENT (SMALL) | |
| | | COUNTY SEAL | |
| | | OTHER CITIES AND VILLAGES | |
| AIRPORT WITH SURFACED RUNWAYS | | UNINCORPORATED VILLAGE OR AREA OF CONCRETE CULTURE | |
| | | MILITARY FIELD | |
| | | AIRPORT, COMPLETE FACILITIES (COMMERCIAL OR MUNICIPAL) | |
| | | AIRFIELD, LIMITED FACILITIES | |
| | | LANDING AREA OR STRIP | |
| | | INCLUDING PRIVATE AIR FIELDS | |
| | | ARRAY LIGHT BEACON (GENERAL) | |
| | | INCORPORATED CITY OR VILLAGE (FIGURES INDICATED 1990 POPULATION) | |
| | | | |

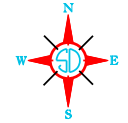
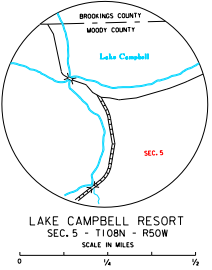

GENERAL HIGHWAY MAP
MOODY COUNTY
 SOUTH DAKOTA

prepared by the
 SOUTH DAKOTA DEPARTMENT OF TRANSPORTATION
 in cooperation with the
 U.S. DEPARTMENT OF TRANSPORTATION
 FEDERAL HIGHWAY ADMINISTRATION



2017

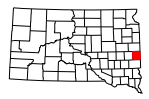

UNIVERSAL TRANSVERSE MERCATOR PROJECTION

RESTRICTION OF LIABILITY: The South Dakota Department of Transportation does not assume any responsibility for the accuracy or completeness of the data and proprietary information appearing on this map. The Department of Transportation is not liable for any errors or omissions in the data, including but not limited to the incorporation of modifications to the data, or for any errors or omissions in the data, including but not limited to the incorporation of modifications to the data, or for any errors or omissions in the data, including but not limited to the incorporation of modifications to the data.

COPIES OF THIS MAP ARE AVAILABLE FOR PUBLIC USE AT A NOMINAL COST
 S.D. Department of Transportation
 Map Sales - (605) 773-3249
 Pierre, South Dakota 57501