

LEGEND

INTERSTATE HIGHWAY (FULL CONTROL OF ACCESS)	UNINCORPORATED VILLAGE OR AREA OF CONGESTED CULTURE
U.S. NUMBERED HIGHWAY	INCORPORATED CITY OR VILLAGE (FIGURES INDICATE 1990 POPULATION)
STATE NUMBERED HIGHWAY	FOREST RANGER STATION
PRIMITIVE ROAD	BATHING BEACH OR SWIMMING POOL
UNIMPROVED ROAD	PLAYGROUND, BALL FIELDS, ETC.
GRADED AND GRADED ROAD	CAMP SITE, NO PERMANENCE
GRAVEL OR STONE SURFACED ROAD	PICNIC GROUND
HARD SURFACED ROAD	SCENIC SITE
DIVIDED HIGHWAY (WITH FRONTAGE ROAD)	TRAVEL COURT OR MOTOR
INTERCHANGE	CAMP OR LODGE
HIGHWAY GRADE SEPARATION	FISH HATCHERY
RAILROAD	REST AREA
RAILROAD IN AUTOMATION	GOLF COURSE OR COUNTRY CLUB
TWO OR MORE TRACKS OF SEPARATELY OPERATED COMPANIES ON ADJACENT RIGHT-OF-WAY	AMUSEMENT MALL OR PARK
RAILROAD CROSSING	SMALL PARK (SP - STATE, WP - WAYSIDE PARK, MP - MUNICIPAL PARK)
GRADE CROSSING	FARMING, RACE COURSE, SKEETRY
RAILROAD ABOVE	DRIVE-IN THEATRE
RAILROAD BELOW	FARM UNIT
APPROACH WITH SURFACED RUNWAYS	DWELLING (OTHER THAN FARM)
MILITARY FIELD	ROW OR GROUPS OF DWELLINGS CLOSELY SPACED
APPROACH, COMPLETE FACILITIES (COMMERCIAL, OR MUNICIPAL)	COMBINED DWELLING AND STORE OR SMALL BUSINESS
APPROACH, LIMITED FACILITIES	DWELLING, BUSINESS, AND FILING STATION
LANDING AREA OR STRIP	DWELLING, BUSINESS, FILING STATION, AND POST OFFICE
WELLING PRIVATE AIR FIELDS	SEASONAL OR SUMMER CLOVER DWELLING (COMMERCIAL, OR MUNICIPAL)
ARENAV LIGHT BEACH (GENERAL)	SEASONAL DWELLINGS CLOSELY SPACED
WIDE STREAM (INTERMEDIATE NAVIGATION)	CHURCH - OTHER RELIGIOUS INSTITUTION
DRAINAGE DITCH (MAN)	CHURCH
BUSINESS AND FILING STATION	CHURCH WITH CEMETERY ADJACENT
RESERVOIR, POND OR LAKE	STONE OR SMALL BUSINESS ESTABLISHMENT
RESERVOIR, WITH DAM	FACTORY OR INDUSTRIAL PLANT
DAM	BUSINESS AND FILING STATION
MARSH OR SWAMP LAND	BUSINESS AND POST OFFICE
DOCK, PIER, OR LANDING	FILING STATION
HIGHWAY BRIDGE (OVER 20 FT. IN LENGTH)	MAR
RAILROAD BRIDGE (CLOSELY SPACED)	IRRA PLANT
CANTILEVER BRIDGE	CALMING OR TRAFFIC STATION (GENERAL)
FORD - ROAD ESTABLISHED	STOCK YARD - LOADING PEN OR CORRAL
OTHER EDUCATIONAL INSTITUTION	GRAVEL PIT
CAUSEWAY	GRAVEL WAREHOUSE (GENERAL), LOVELY, ADD US OR STATE
ADMINISTRATIVE BUILDING	MURKIN
POST OFFICE	SCHOOLHOUSE
PROMONT ELEVATION	CONSOLIDATED OR LAKE SCHOOL
STATE LINE	OTHER EDUCATIONAL INSTITUTION
COUNTY LINE	TOWNHALL, GRANGE, OR COMMUNITY HALL
CONGRESSIONAL TOWNSHIP LINE	ADMINISTRATIVE BUILDING
SECTION LINE	POST OFFICE
FEDERAL AND STATE RESERVATION BOUNDARY LINE	HIGHWAY GARAGE (COUNTY, STATE OR FEDERAL)
COUNTY SEAT	WATER SUPPLY STAND PIPE OR TANK
OTHER CITIES AND VILLAGES	COMBINATION TOWER - TELEPHONE, RGA ETC.
	POWER SUBSTATION
	RADIO OR TV STATION (WITH CALL LETTERS)
	RAILROAD STATION
	GARAGE OR RUMBLE DAMP
	MOMENT (SMALL)
	SEWAGE DISPOSAL PLANT
	TRANSLATION STATION
	LOCATION OF CULTURE MADE MAP SCALE
	DOES NOT PERMIT PLACING OF SYMBOL

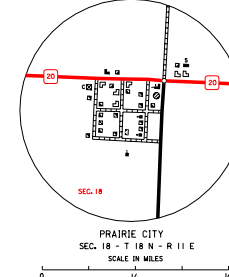
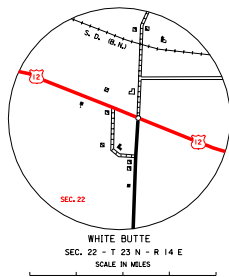
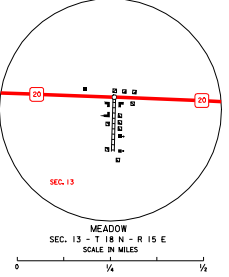

GENERAL HIGHWAY MAP
NORTH HALF PERKINS COUNTY
SOUTH DAKOTA

prepared by the
 SOUTH DAKOTA DEPARTMENT OF TRANSPORTATION
 in cooperation with the
 U.S. DEPARTMENT OF TRANSPORTATION
 FEDERAL HIGHWAY ADMINISTRATION

SCALE
 0 1 2 3 4 5 MILES

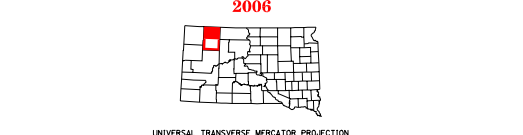

UNIVERSAL TRANSVERSE MERCATOR PROJECTION

COPIES OF THIS MAP ARE AVAILABLE FOR PUBLIC USE AT A NOMINAL COST
 S.D. Department of Transportation
 Map Room - P.O. Box 672333
 Pierre, South Dakota 57501