

LEGEND

- INTERSTATE HIGHWAY (FULL CONTROL OF ACCESS)
- U S NUMBERED HIGHWAY
- STATE NUMBERED HIGHWAY
- PRIMITIVE ROAD
- UNIMPROVED ROAD
- GRADED AND DRAINED ROAD
- GRAVEL OR STONE SURFACED ROAD
- HARD SURFACED ROAD
- DIVIDED HIGHWAY (WITH ELEVATION ROAD)
- INTERCHANGE
- HIGHWAY GRADE SEPARATION
- POINTS BETWEEN WHICH DISTANCES ARE MEASURED INDICATED THUS
- RAILROAD
- RAILROADS IN JUXTAPOSITION
- TWO OR MORE TRACKS OF SEPARATELY OPERATED COMPANIES ON ADJACENT RIGHT-OF-WAY
- RAILROAD CROSSINGS
- GRADE CROSSINGS
- RAILROAD ABOVE
- RAILROAD BELOW
- AIRPORT WITH SURFACED RUNWAYS
- MILITARY FIELD
- AIRPORT, COMPLETE FACILITIES (COMMERCIAL OR MUNICIPAL)
- ARIELD, LIMITED FACILITIES
- LANDING AREA OR STRIP
- WELLING PRIVATE AIR FIELDS
- ARRAY LIGHT BEACON (GENERAL)
- NARROW STREAM
- RICE STREAM (PERMITMENT NAVIGATION)
- DRAINAGE DITCH (MAIN)
- IRRIGATION DITCH
- RESERVOIR, POND OR LAKE
- RESERVOIR, WITH DAM
- DAM
- MARSH OR SWAMP LAND
- DOCK, PIER, OR LANDING
- HIGHWAY BRIDGE (OVER 20 FT. IN LENGTH)
- HIGHWAY BRIDGES CLOSELY SPACED
- STEEL TRUSS BRIDGE LARGE
- CANTILEVER BRIDGE
- FORD - ROAD ESTABLISHED
- CONCRETE FORD
- CAUSEWAY - GRAVEL, OR COUNTY HALL
- ADMINISTRATION BUILDING
- POST OFFICE
- HIGHWAY GARAGE - COUNTY, STATE OR FEDERAL
- WATER SUPPLY STAND PIPE OR TANK
- COMMUNICATION TOWER - TELEPHONE, REA ETC.
- COUNTY LINE
- CONGRESSIONAL TOWNSHIP LINE
- SECTION LINE
- FEDERAL AND STATE RESERVATION BOUNDARY LINE
- MONUMENT (SMALL)
- COUNTY SEAT
- TRIANGULATION STATION
- OTHER CITIES AND VILLAGES
- UNINCORPORATED VILLAGE OR AREA OF CONGESTED CULTURE
- INCORPORATED CITY OR VILLAGE (FIGURES INDICATED 1990 POPULATION)
- FOREST RANGER STATION
- BATHING BEACH OR SWIMMING POOL
- PLAYGROUND, BALL FIELD, ETC.
- CAMP SITE, NO PERMANENCE
- PICNIC GROUND
- SCENIC SITE
- TOURIST COURT OR HOTEL
- CAMP OR LODGE
- FISH HATCHERY
- REST AREA
- GOLF COURSE OR COUNTRY CLUB
- AMUSEMENT HALL OR PARK
- SMALL PARK (SP - STATE, MP - RAYSDALE PARK, MP - MUNICIPAL PARK)
- FARROWING, RACE COURSE, SPEEDWAY
- DRIVE - IN THEATRE
- FARM UNIT (OTHER THAN FARM)
- DWELLING (OTHER THAN FARM)
- ROW OR GROUPS OF DWELLINGS CLOSELY SPACED
- COMBINED DWELLING AND STORE OR SMALL BUSINESS
- DWELLING, BUSINESS, AND FILING STATION
- DWELLING, BUSINESS, FILING STATION, AND POST OFFICE
- STATE PORT OF ENTRY OR NEIGH STATION
- SEASONAL OR SUMMER COLONY DWELLING
- SEASONAL DWELLINGS CLOSELY SPACED
- CHURCH - OTHER RELIGIOUS INSTITUTION
- CENETARY
- CHURCH WITH CENETARY ADJACENT
- STORE OR SMALL BUSINESS ESTABLISHMENT
- FACTORY OR INDUSTRIAL PLANT
- BUSINESS AND FILING STATION
- BUSINESS AND POST OFFICE
- FILING STATION
- MINE
- BULK PLANT
- GAUGING OR PUMPING STATION (GENERAL)
- STOCK YARD - LOADING PEN OR CORRAL
- GRAVEL PIT
- GRAN ELEVATOR
- WAREHOUSE (GENERAL) GOV'T. ADD US OR STATE
- NURSERY
- SCHOOLHOUSE
- FORD - ROAD ESTABLISHED
- OTHER EDUCATIONAL INSTITUTION
- TOWNHALL, GRANGE, OR COUNTY HALL
- ADMINISTRATION BUILDING
- POST OFFICE
- HIGHWAY GARAGE - COUNTY, STATE OR FEDERAL
- WATER SUPPLY STAND PIPE OR TANK
- COMMUNICATION TOWER - TELEPHONE, REA ETC.
- RADIO OR TV STATION (WITH CALL LETTERS)
- RADIO RANGE STATION
- GARBAGE OR RUBBISH DUMP
- SEWAGE DISPOSAL PLANT
- TRIANGULATION STATION
- LOCATION OF CULTURE WHERE MAP SCALE DOES NOT PERMIT PLACING OF SYMBOL

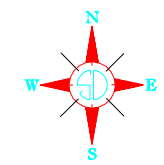
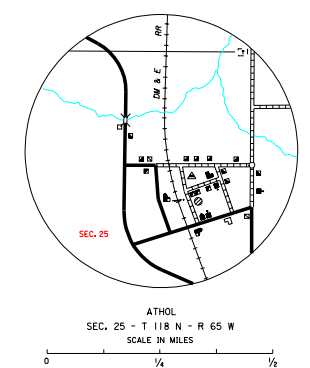
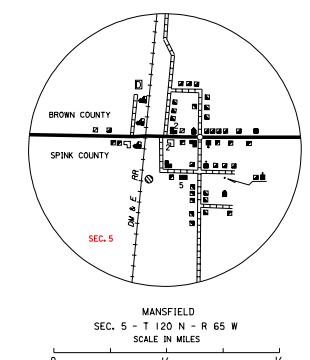

GENERAL HIGHWAY MAP  
NORTH HALF  
**SPINK COUNTY**  
SOUTH DAKOTA

prepared by the  
SOUTH DAKOTA DEPARTMENT OF TRANSPORTATION  
in cooperation with the  
U.S. DEPARTMENT OF TRANSPORTATION  
FEDERAL HIGHWAY ADMINISTRATION

SCALE  
0 2 3 4 5 MILES

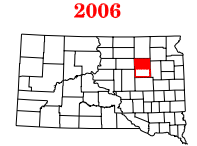

UNIVERSAL TRANSVERSE MERCATOR PROJECTION  
U.S. and State numbered Highways and  
the Federal-Aid Primary and Federal-Aid  
Secondary systems as of May 31, 1986

COPIES OF THIS MAP ARE AVAILABLE  
FOR PUBLIC USE AT A NOMINAL COST  
S. D. Department of Transportation  
Map Sales - - - Ph. (605) 773 3249  
Pierre, South Dakota 57501