

LEGEND

INTERSTATE HIGHWAY (FULL CONTROL OF ACCESS)		UNINCORPORATED VILLAGE OR AREA OF CONGESTED CULTURE	
U.S. NUMBERED HIGHWAY		INCORPORATED CITY OR VILLAGE (FIGURES INDICATED 1990 POPULATION)	
STATE NUMBERED HIGHWAY		POP. 231	
PRIMITIVE ROAD		FOREST RANGER STATION	
UNIMPROVED ROAD		BATHING BEACH OR SWIMMING POOL	
GRADED AND DRAINED ROAD		PLAYGROUND, BALL FIELD, ETC.	
GRAVEL OR STONE SURFACED ROAD		CAMP SITE, NO PERMANENCE	
HARD SURFACED ROAD		PICNIC GROUND	
DIVIDED HIGHWAY (WITH FRONTAGE ROAD)		SCENE SITE	
INTERCHANGE		TOURIST COURT OR MOTEL	
HIGHWAY GRADE SEPARATION		CAMP OR LODGE	
POINTS BETWEEN WHICH DISTANCES ARE MEASURED INDICATED THIS		FISH HATCHERY	
RAILROAD		REST AREA	
RAILROADS IN JUNCTAPOSITION		GOLF COURSE OR COUNTRY CLUB	
TWO OR MORE TRACKS OF SEPARATELY OPERATED COMPANIES ON ADJACENT RIGHT-OF-WAY		AMUSEMENT HALL OR PARK	
RAILROAD CROSSINGS		SMALL PARK (SP - STATE, WP - WAYSIDE PARK, MP - MUNICIPAL PARK)	
GRADE CROSSINGS		FARROWING, RACE COURSE, SPEEDWAY	
RAILROAD ABOVE		DRIVE-IN THEATRE	
RAILROAD BELOW		FARM UNIT	
NOT IN USE		NOT IN USE	
IN USE		IN USE	
DRIVING (OTHER THAN FARM)		ROW OR GROUPS OF DWELLINGS CLOSELY SPACED	
COMBINED DWELLING AND STORE OR SMALL BUSINESS		DWELLING, BUSINESS, AND FILING STATION	
DWELLING, BUSINESS, AND FILING STATION		DRILLING, BUSINESS, FILING STATION, AND POST OFFICE	
DRILLING, BUSINESS, FILING STATION, AND POST OFFICE		STATE POINT OF ENTRY OR BOAT STATION	
STATE POINT OF ENTRY OR BOAT STATION		SEASONAL OR SUMMER COLONY DWELLING	
SEASONAL OR SUMMER COLONY DWELLING		SEASONAL DWELLINGS CLOSELY SPACED	
SEASONAL DWELLINGS CLOSELY SPACED		CHURCH - OTHER RELIGIOUS INSTITUTION	
CHURCH - OTHER RELIGIOUS INSTITUTION		CEMETARY	
CEMETARY		CHURCH WITH CEMETARY ADJACENT	
CHURCH WITH CEMETARY ADJACENT		STORE OR SMALL BUSINESS ESTABLISHMENT	
STORE OR SMALL BUSINESS ESTABLISHMENT		FACTORY OR INDUSTRIAL PLANT	
FACTORY OR INDUSTRIAL PLANT		BUSINESS AND FILING STATION	
BUSINESS AND FILING STATION		BUSINESS AND POST OFFICE	
BUSINESS AND POST OFFICE		FILING STATION	
FILING STATION		MINE	
MINE		BULK PLANT	
BULK PLANT		GALVING OR PUMPING STATION (GENERAL)	
GALVING OR PUMPING STATION (GENERAL)		STOCK YARD - LOADING PEN OR CORRAL	
STOCK YARD - LOADING PEN OR CORRAL		GRAVEL PIT	
GRAVEL PIT		GRAN ELEVATOR	
GRAN ELEVATOR		WAREHOUSE (GENERAL) GOVT. ADD US OR STATE	
WAREHOUSE (GENERAL) GOVT. ADD US OR STATE		NURSERY	
NURSERY		SCHOOLHOUSE	
SCHOOLHOUSE		CONSOLIDATED OR LARGE SCHOOL	
CONSOLIDATED OR LARGE SCHOOL		OTHER EDUCATIONAL INSTITUTION	
OTHER EDUCATIONAL INSTITUTION		CAUSEWAY	
CAUSEWAY		ADMINISTRATION BUILDING	
ADMINISTRATION BUILDING		POST OFFICE	
POST OFFICE		HIGHWAY GARAGE (COUNTY, STATE OR FEDERAL)	
HIGHWAY GARAGE (COUNTY, STATE OR FEDERAL)		WATER SUPPLY STAND PIPE OR TANK	
WATER SUPPLY STAND PIPE OR TANK		COMMUNICATION TOWER - TELEPHONE, REA ETC.	
COMMUNICATION TOWER - TELEPHONE, REA ETC.		POWER SUBSTATION	
POWER SUBSTATION		RADIO OR TV STATION (WITH CALL LETTERS)	
RADIO OR TV STATION (WITH CALL LETTERS)		RADIO RANGE STATION	
RADIO RANGE STATION		GARBAGE OR RUBBISH DUMP	
GARBAGE OR RUBBISH DUMP		SEWAGE DISPOSAL PLANT	
SEWAGE DISPOSAL PLANT		TRIANGULATION STATION	
TRIANGULATION STATION		LOCATION OF CULTURE WHERE MAP SCALE DOES NOT PERMIT PLACING OF SYMBOL	
LOCATION OF CULTURE WHERE MAP SCALE DOES NOT PERMIT PLACING OF SYMBOL			

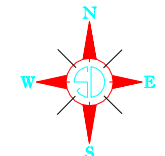
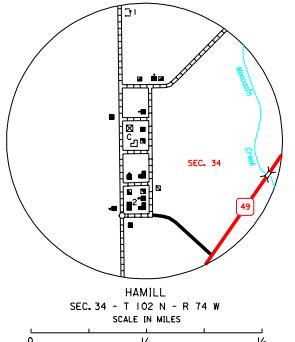
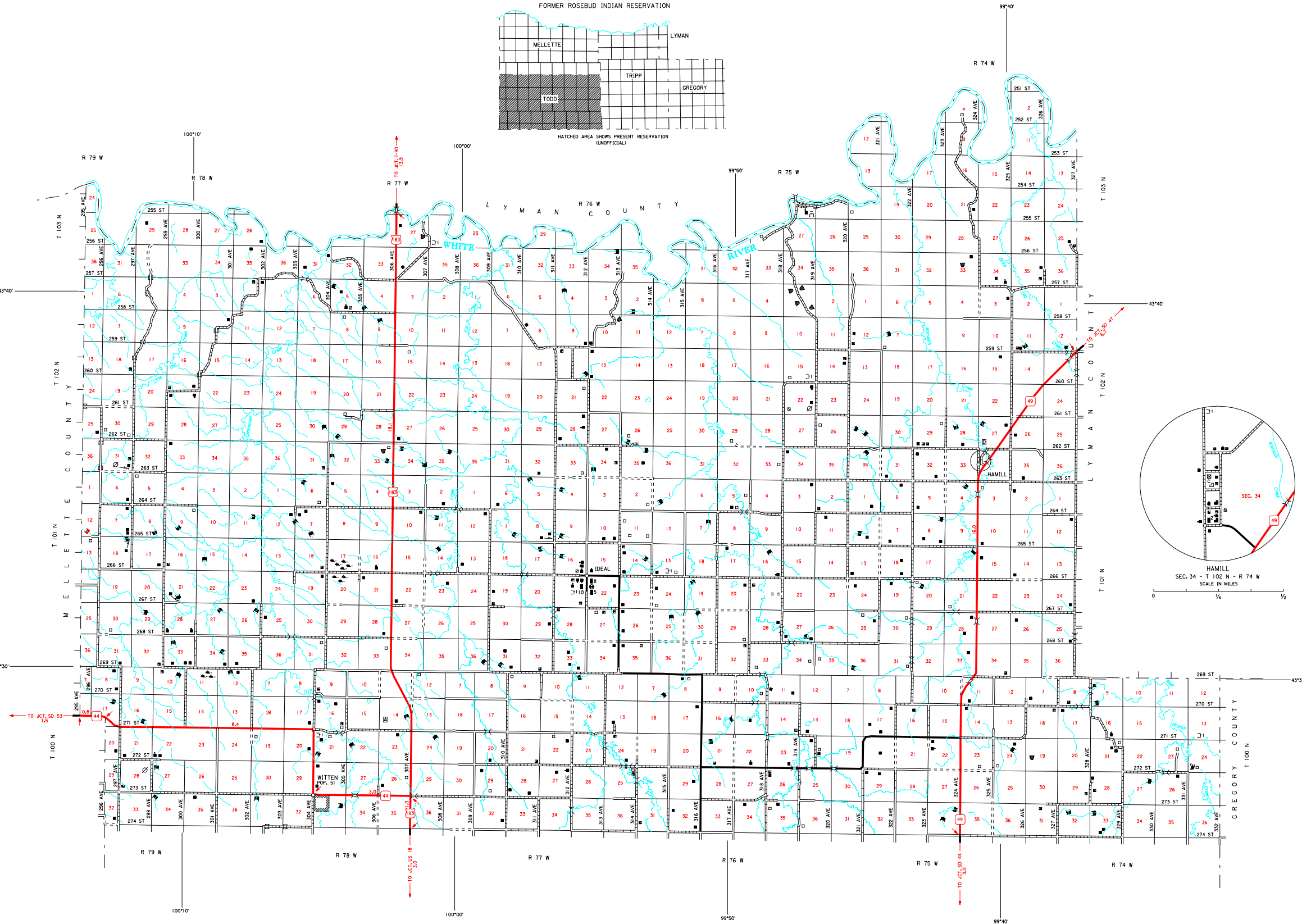
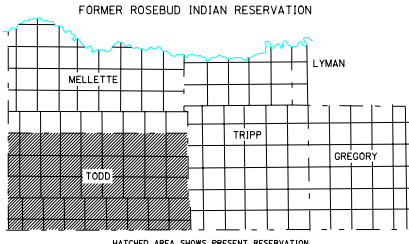

GENERAL HIGHWAY MAP
NORTH HALF
TRIPP COUNTY
SOUTH DAKOTA

prepared by the
SOUTH DAKOTA DEPARTMENT OF TRANSPORTATION
in cooperation with the
U.S. DEPARTMENT OF TRANSPORTATION
FEDERAL HIGHWAY ADMINISTRATION

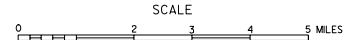

2006

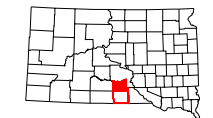

UNIVERSAL TRANSVERSE MERCATOR PROJECTION

U.S. and State numbered Highways and
the Federal-Aid Primary and Federal-Aid
Secondary systems as of Sept. 30, 1982

COPIES OF THIS MAP ARE AVAILABLE
FOR PUBLIC USE AT A NOMINAL COST
S. D. Department of Transportation
Map Sales - P.O. Box 1773, 57501
Pierre, South Dakota 57501