

GENERAL HIGHWAY MAP ZIEBACH COUNTY SOUTH DAKOTA

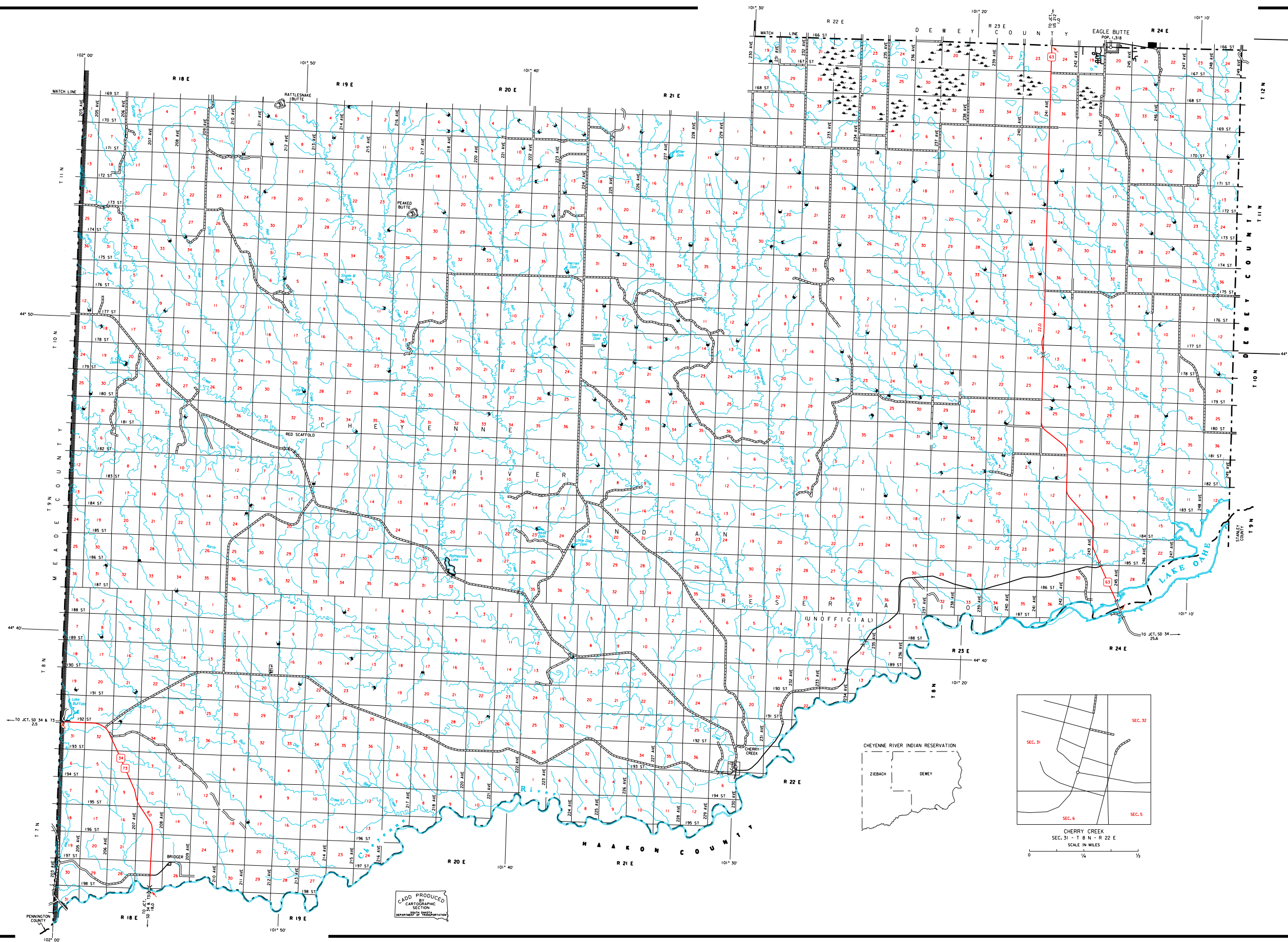

LEGEND

INTERSTATE HIGHWAY (FULL CONTROL OF ACCESS)	ROADWAY BRIDGE (OVER 20 FT. IN LENGTH)	NARROW STREAM
U.S. NUMBERED HIGHWAY	STEEL TRUSS BRIDGE (CLOSELY SPACED)	WIDE STREAM (INTERMITTENT NAVIGATION)
STATE NUMBERED HIGHWAY	CANTILEVER BRIDGE	DRAINAGE DITCH (MAIN)
FEDERAL AID HIGHWAY SYSTEM	CONCRETE FORD	IRRIGATION DITCH
FEDERAL AID SECONDARY HIGHWAY SYSTEM	CAUSEWAY	FAS
END OF FEDERAL AID DESIGNATED ROUTE	PRONOTICE ELEVATION	RESERVOIR, POND OR LAKE
PRIMITIVE ROAD	STATE LINE	RESERVOIR, WITH DAM
UNIMPROVED ROAD	COUNTY LINE	DAM
GRAVEL OR DRAGGED ROAD	CONGRESSIONAL TOWNSHIP LINE	MARSH OR SWAMP LAND
GRAVEL OR STONE SURFACED ROAD	FEDERAL AND STATE RESERVATION BOUNDARY LINE	DOCK, PIER, OR LANDING
HARD SURFACED ROAD	MONUMENT (SMALL)	UNINCORPORATED CITY OR VILLAGE
DIVIDED HIGHWAY (LEFT-EDGEMARKED ROAD)	COUNTY SEAT	INCORPORATED CITY OR VILLAGE
INTERCHANGE	OTHER CITIES AND VILLAGES	(FIGURES INDICATED 1990 POPULATION)
HIGHWAY GRADE SEPARATION	UNINCORPORATED VILLAGE OR AREA OF CONGESTED TRAFFIC	
POINTS BETWEEN WHICH DISTANCES ARE MEASURED INDICATED THIS WAY		
RAILROAD		
RAILROADS IN ADJUTATION		
TWO OR MORE TRACKS OF SEPARATELY OPERATED COMPANIES ON ADJACENT RIGHT-OF-WAY		
RAILROAD CROSSINGS		
RAILROAD ABOVE		
RAILROAD BELOW		
RAILROAD WITH SURFACED RUNWAYS		
MILITARY FIELD		
AIRPORT, COMPLETE FACILITIES (COMMERCIAL OR MUNICIPAL)		
AIRFIELD, LIMITED FACILITIES		
LANDING AREA OR STRIP (INCLUDING PRIVATE AIR FIELDS)		
ARMY LIGHT BEACON (GENERAL)		

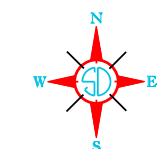

GENERAL HIGHWAY MAP
SOUTH HALF
ZIEBACH COUNTY
SOUTH DAKOTA

prepared by the
SOUTH DAKOTA DEPARTMENT OF TRANSPORTATION
 in cooperation with the
U.S. DEPARTMENT OF TRANSPORTATION
FEDERAL HIGHWAY ADMINISTRATION

SCALE
 0 1 2 3 4 5 MILES

2017

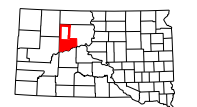

UNIVERSAL TRANSVERSE MERCATOR PROJECTION

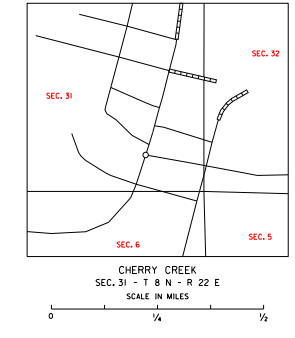

MAP PRODUCED BY
 CARTOGRAPHIC SECTION
 DEPARTMENT OF TRANSPORTATION

RESTRICTION OF LIABILITY: The South Dakota Department of Transportation makes no guarantee or warranties about the accuracy, completeness or timeliness of the data and hereby disclaims liability for errors and omissions of the data contents. No warranty of any kind, express or implied, is made by the Department of Transportation, including but not limited to the warranties of merchantability and fitness for a particular purpose is given with respect to this data.

COPIES OF THIS MAP ARE AVAILABLE FOR PUBLIC USE AT A NOMINAL COST
 S.D. Department of Transportation
 Map Sale - PA 6051773 3249
 Pierre, South Dakota 57501