

MAGNETOMETER MAP of SOUTHEASTERN SOUTH DAKOTA by Bruno C. Petsch 1962

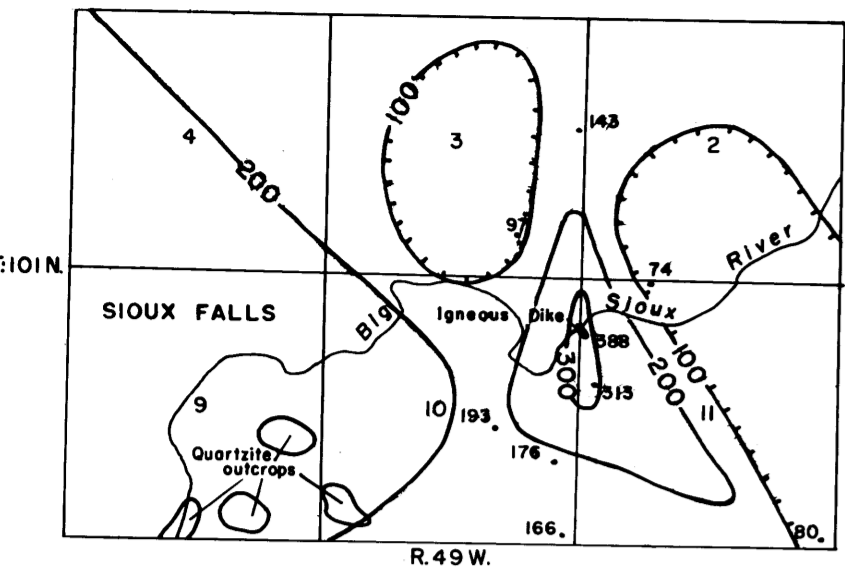

Figure 10. Magnetometer High at the Igneous Dike just northeast of Sioux Falls.

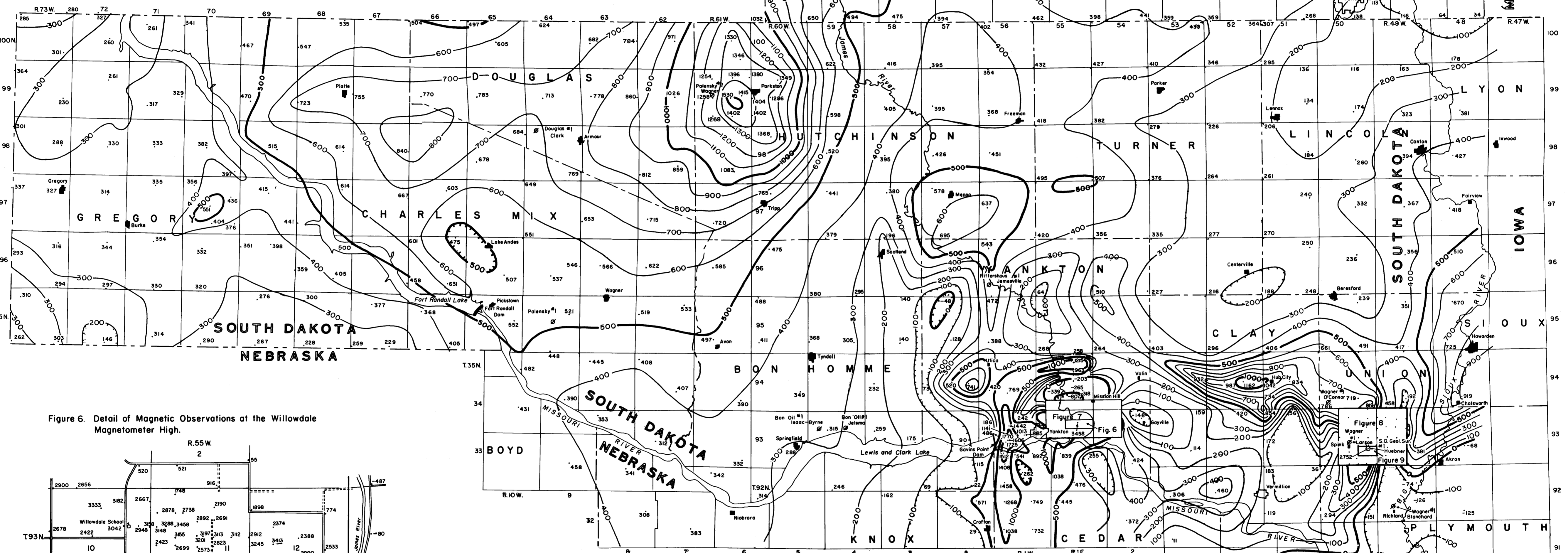

Figure 6. Detail of Magnetic Observations at the Willowdale Magnetometer High.

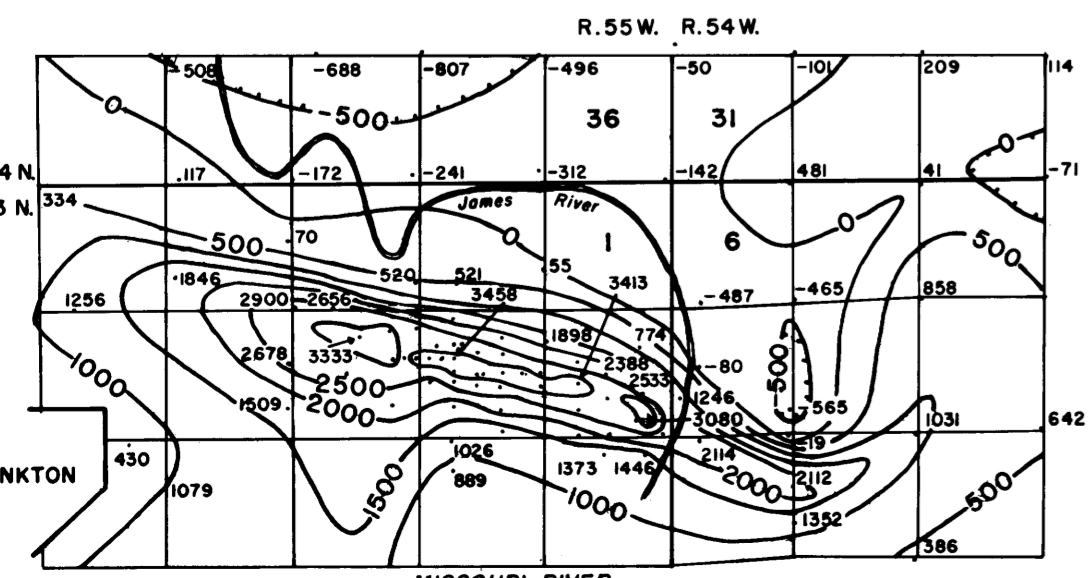
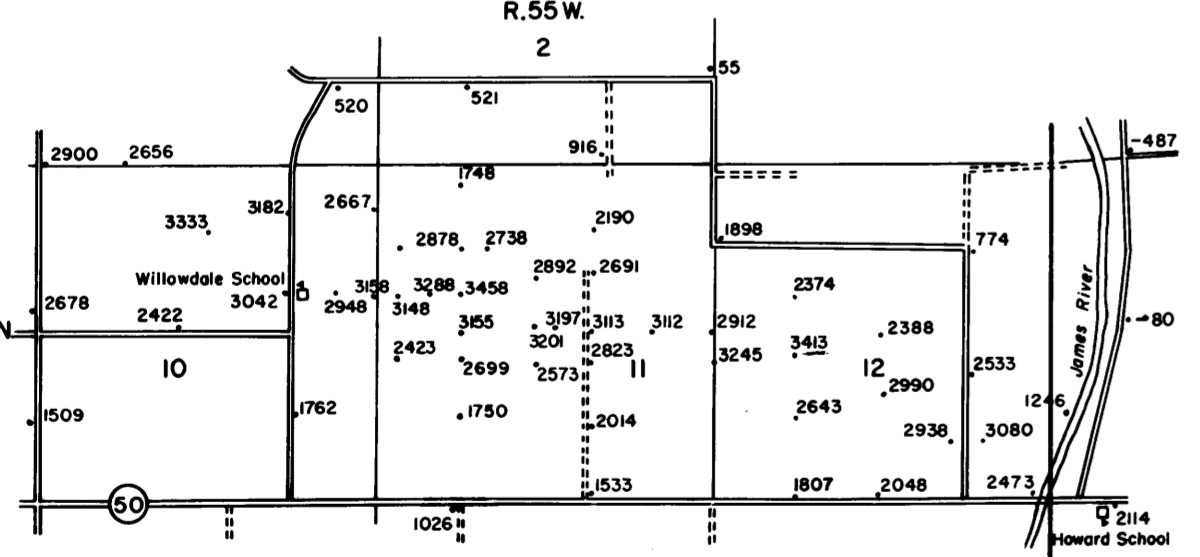

Figure 7. The Willowdale Magnetometer High. (Interval 500 Gammas)

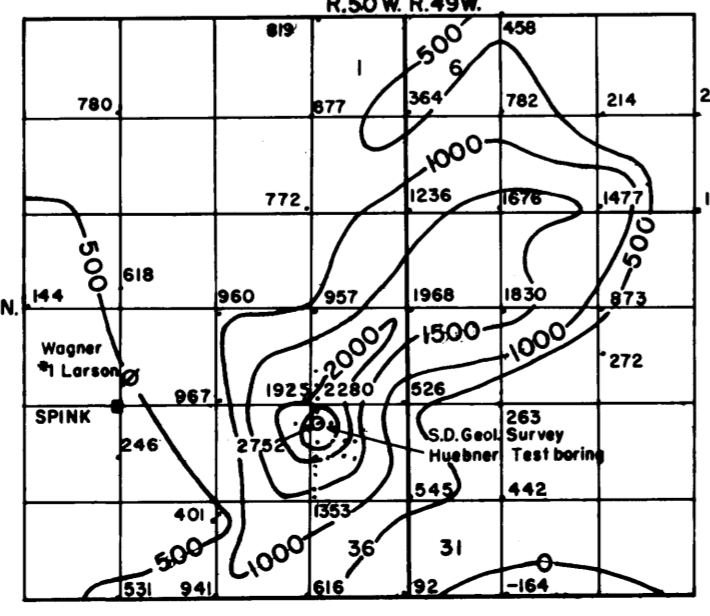

Figure 8. The Spink Magnetometer High. (Interval 500 Gammas)

- EXPLANATION**
- 3458 Magnetic Observation in Gammas. Vertical Intensity
 - Isogam showing line of equal magnetic intensity.
 - Low magnetic intensity.
 - ⊗ Oil test to Precambrian.

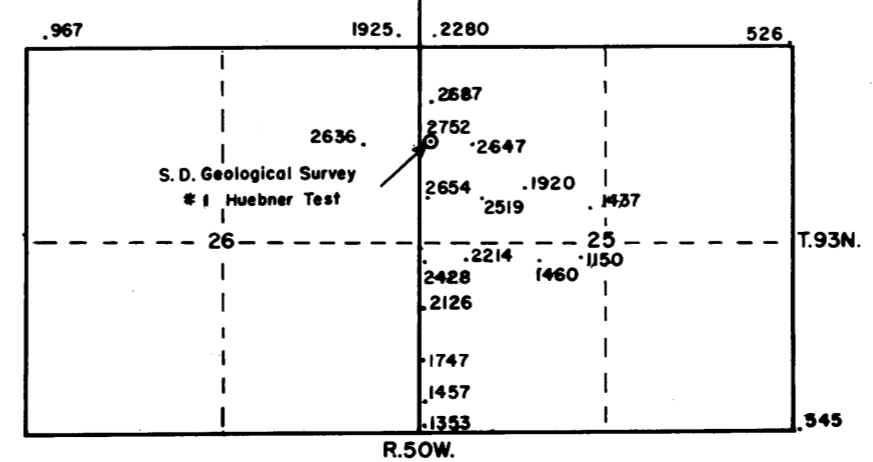

Figure 9. Detail of Magnetic Observations at the Spink Magnetometer High.

